

OBS: CONFERIR MEDIDAS NO LOCAL

LAYOUT ATUAL

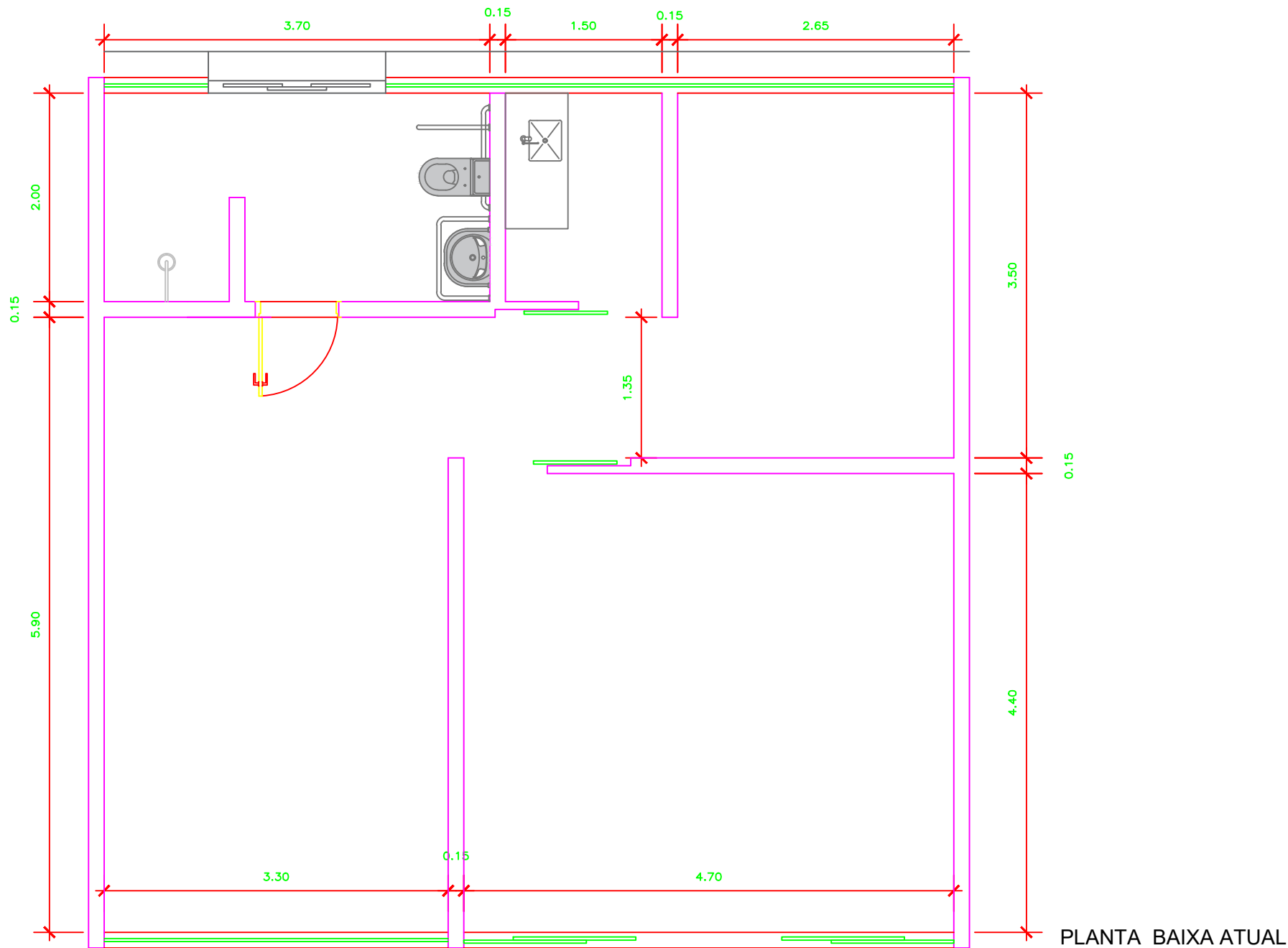

OBS: CONFERIR MEDIDAS NO LOCAL

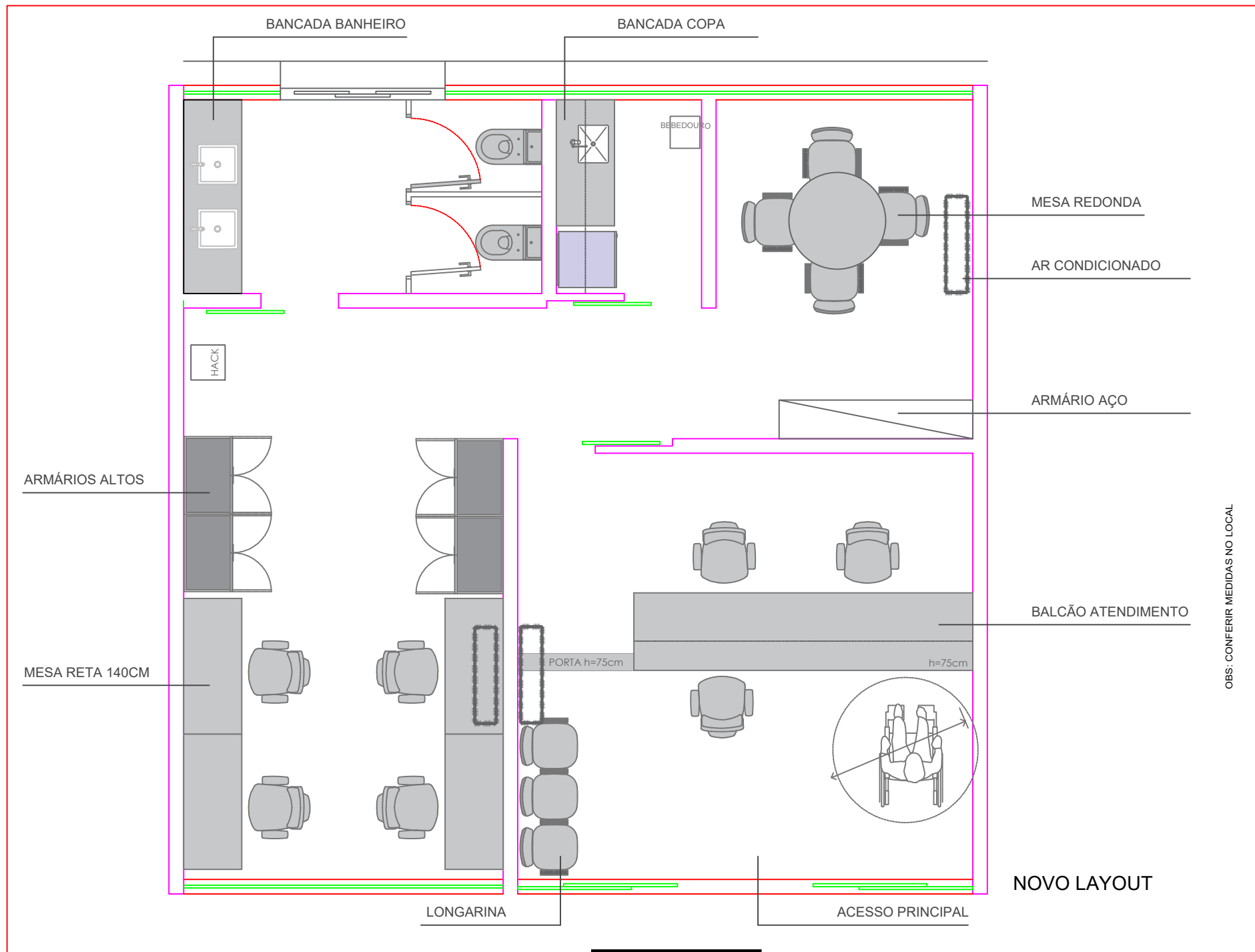

OBS: CONFERIR MEDIDAS NO LOCAL

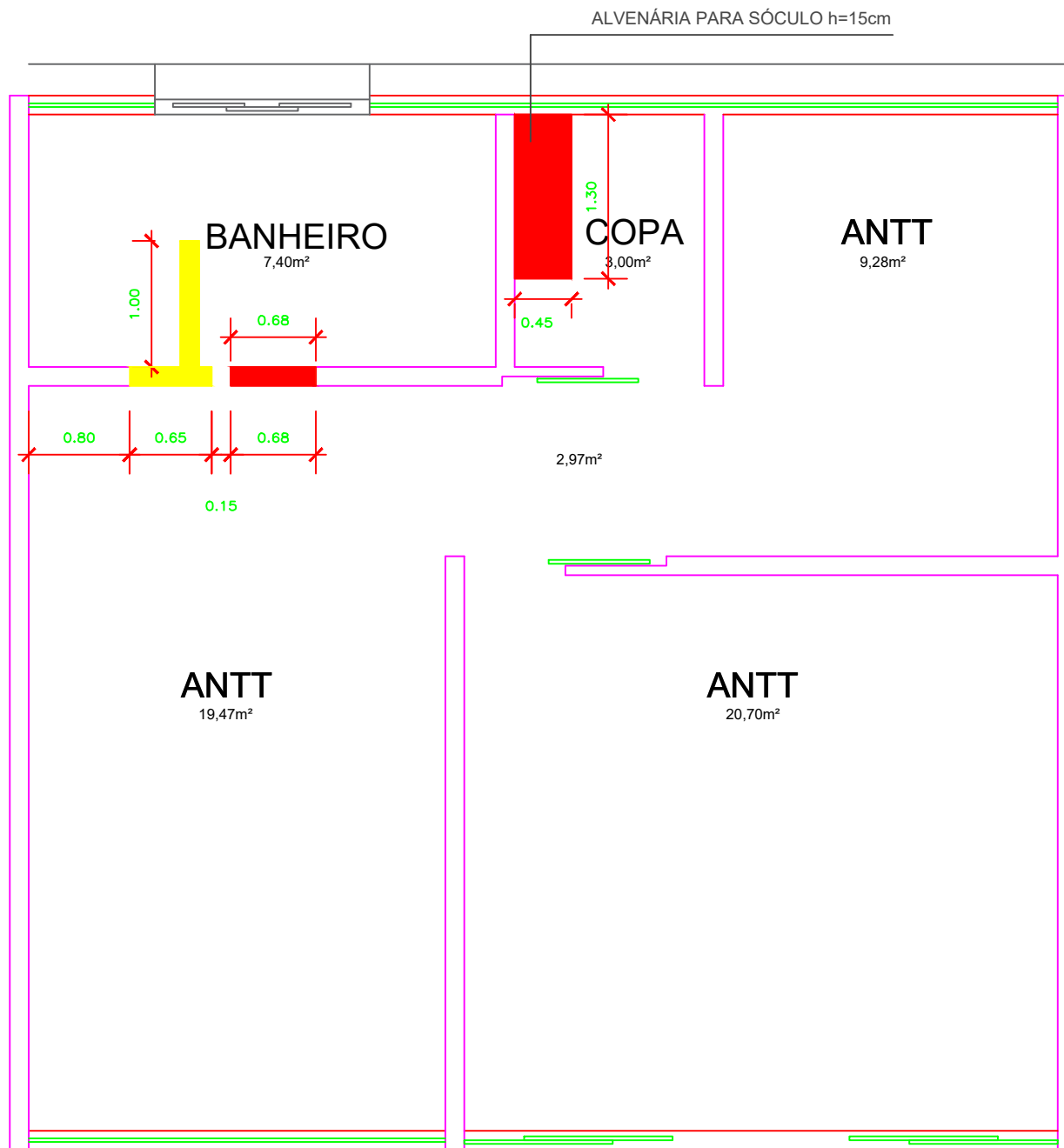

OBS: CONFERIR MEDIDAS NO LOCAL

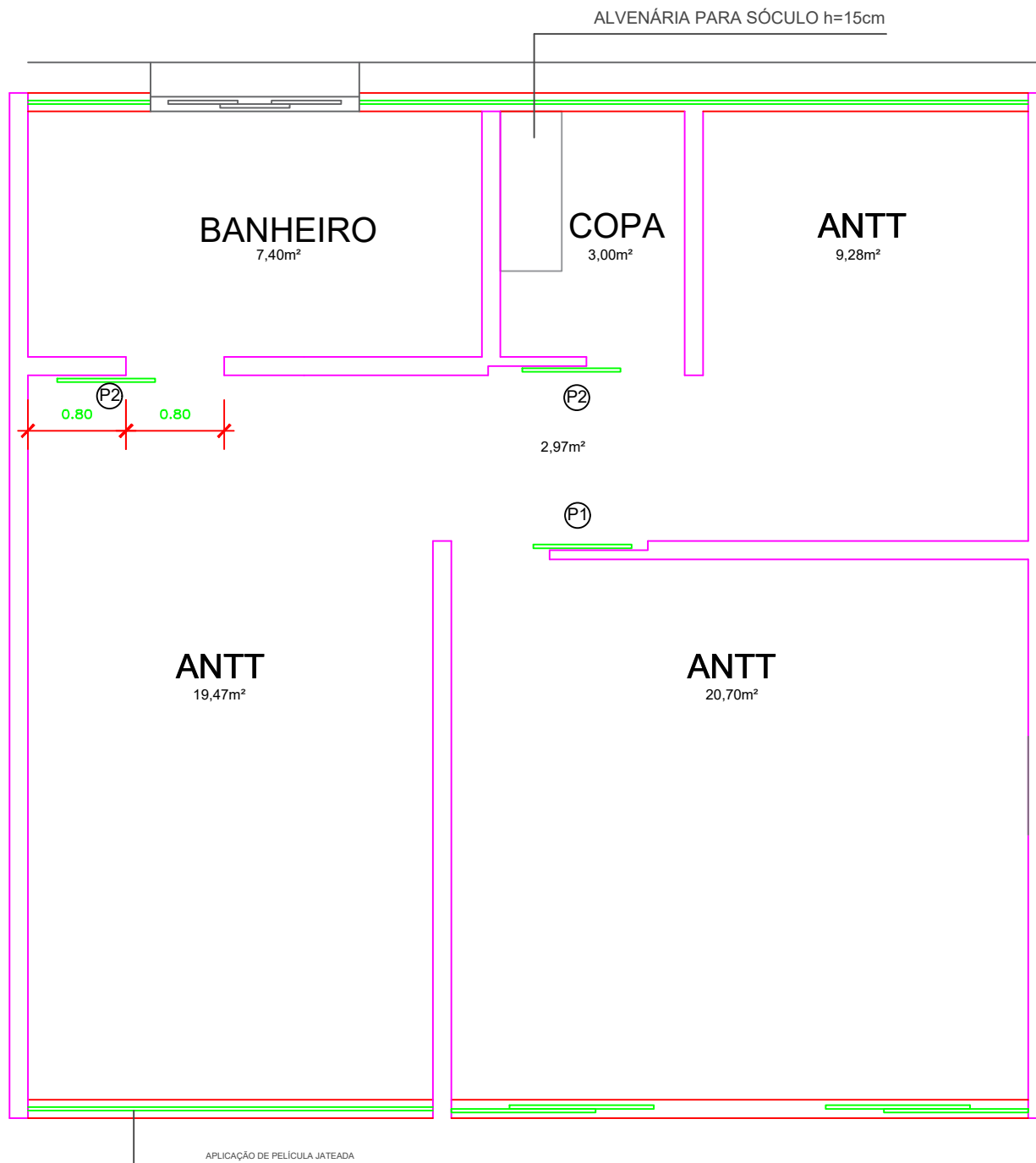

OBS: CONFERIR MEDIDAS NO LOCAL

| ITEM. | ESQUADRIAS                            | QUANT. |
|-------|---------------------------------------|--------|
| P1    | Porta de correr em vidro 0,80x2,10m   | 1      |
| P2    | Porta de correr em madeira 0,80x2,10m | 2      |

EXECUTIVO

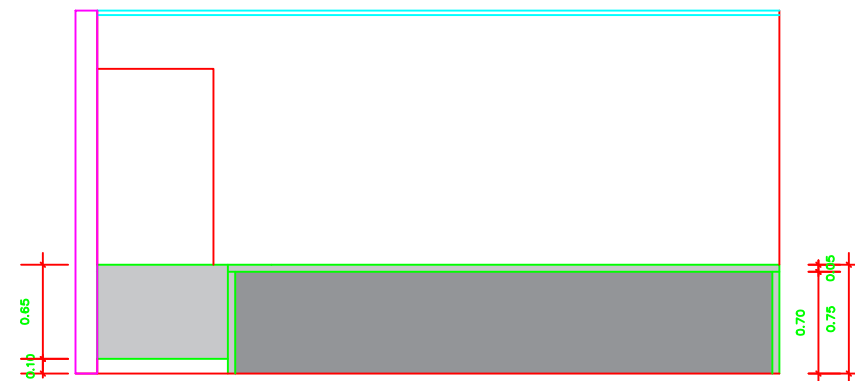
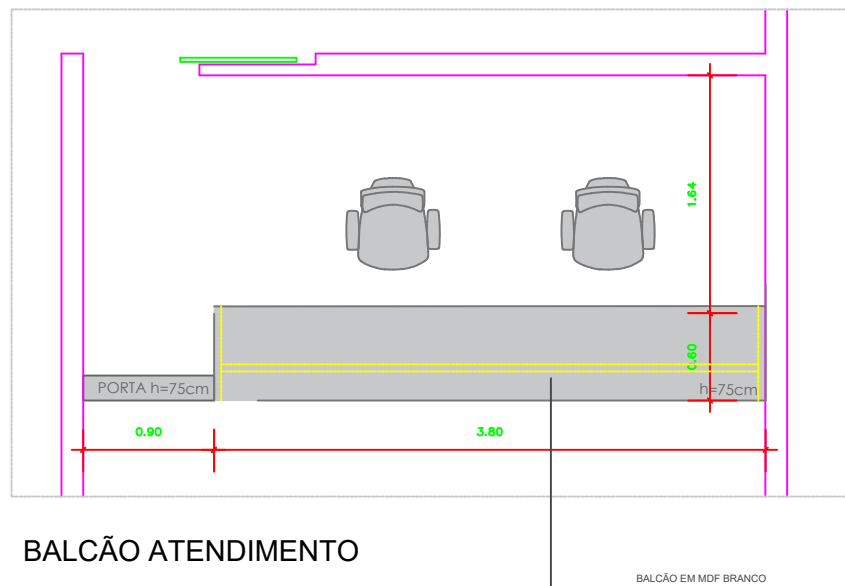

OBS: CONFERIR MEDIDAS NO LOCAL

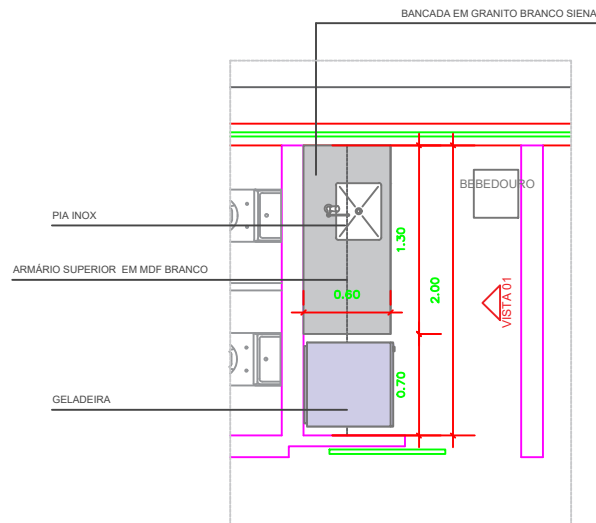

COPA

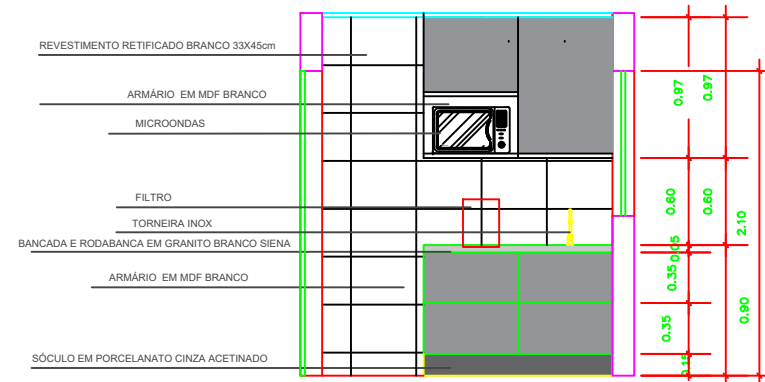

VISTA 01 - COPA

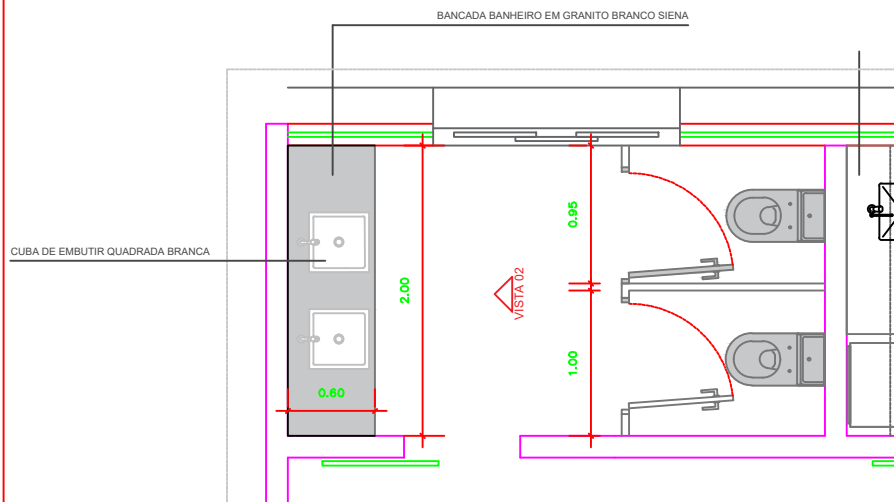

BANCADA BANHEIRO

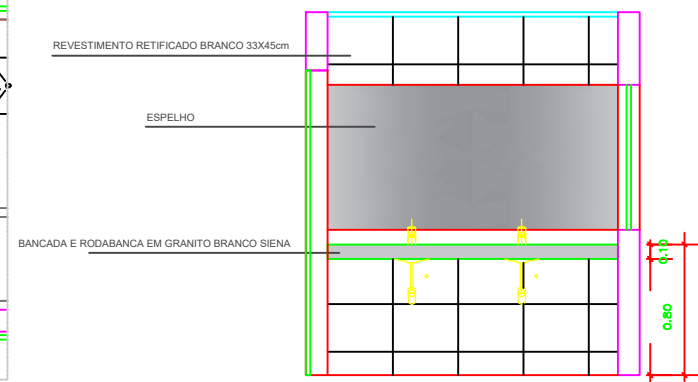

VISTA 02 - BANHEIRO

OBS: CONFERIR MEDIDAS NO LOCAL

OBS: CONFERIR MEDIDAS NO LOCAL

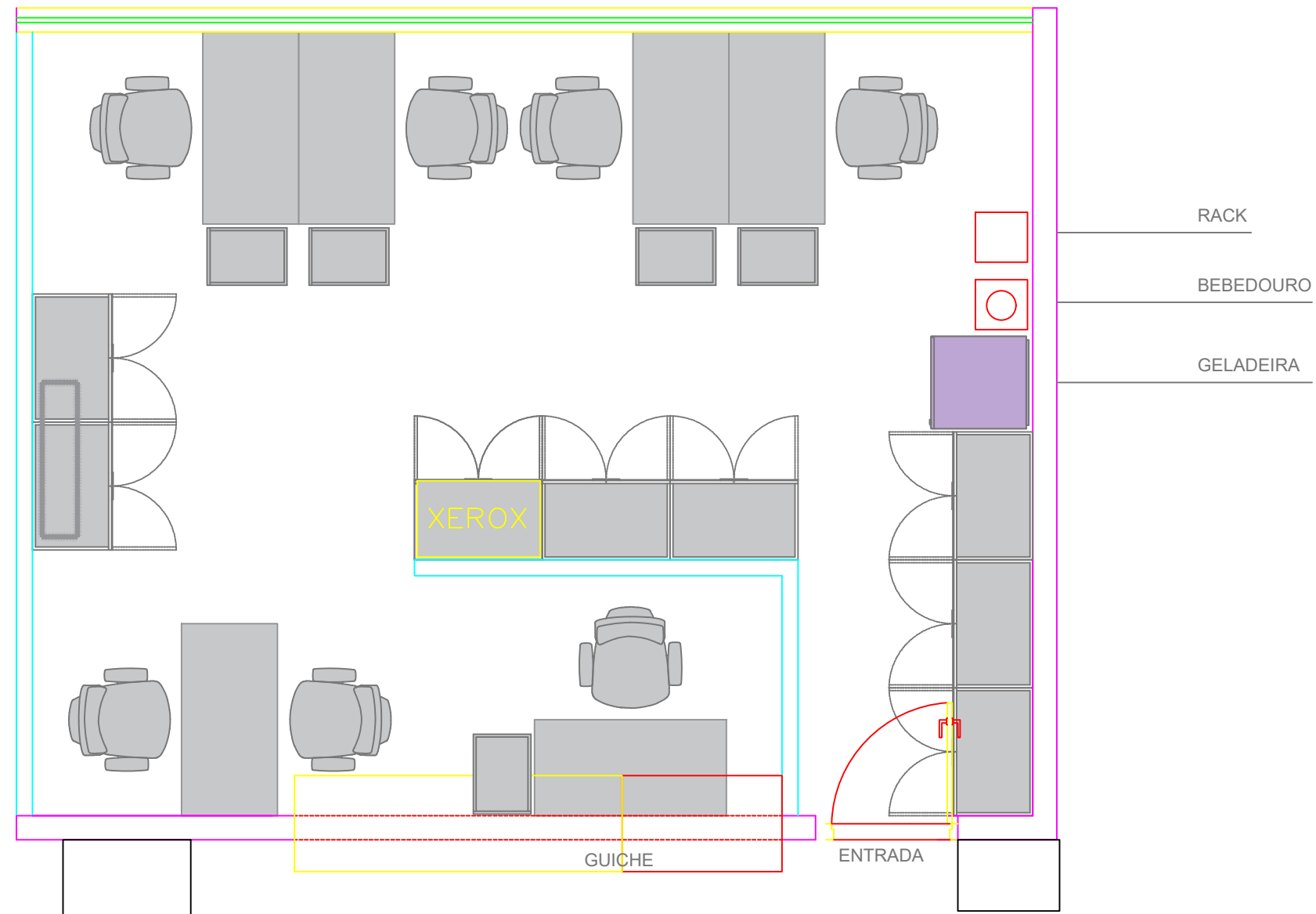

LAYOUT ATUAL



OBS: CONFERIR MEDIDAS NO LOCAL

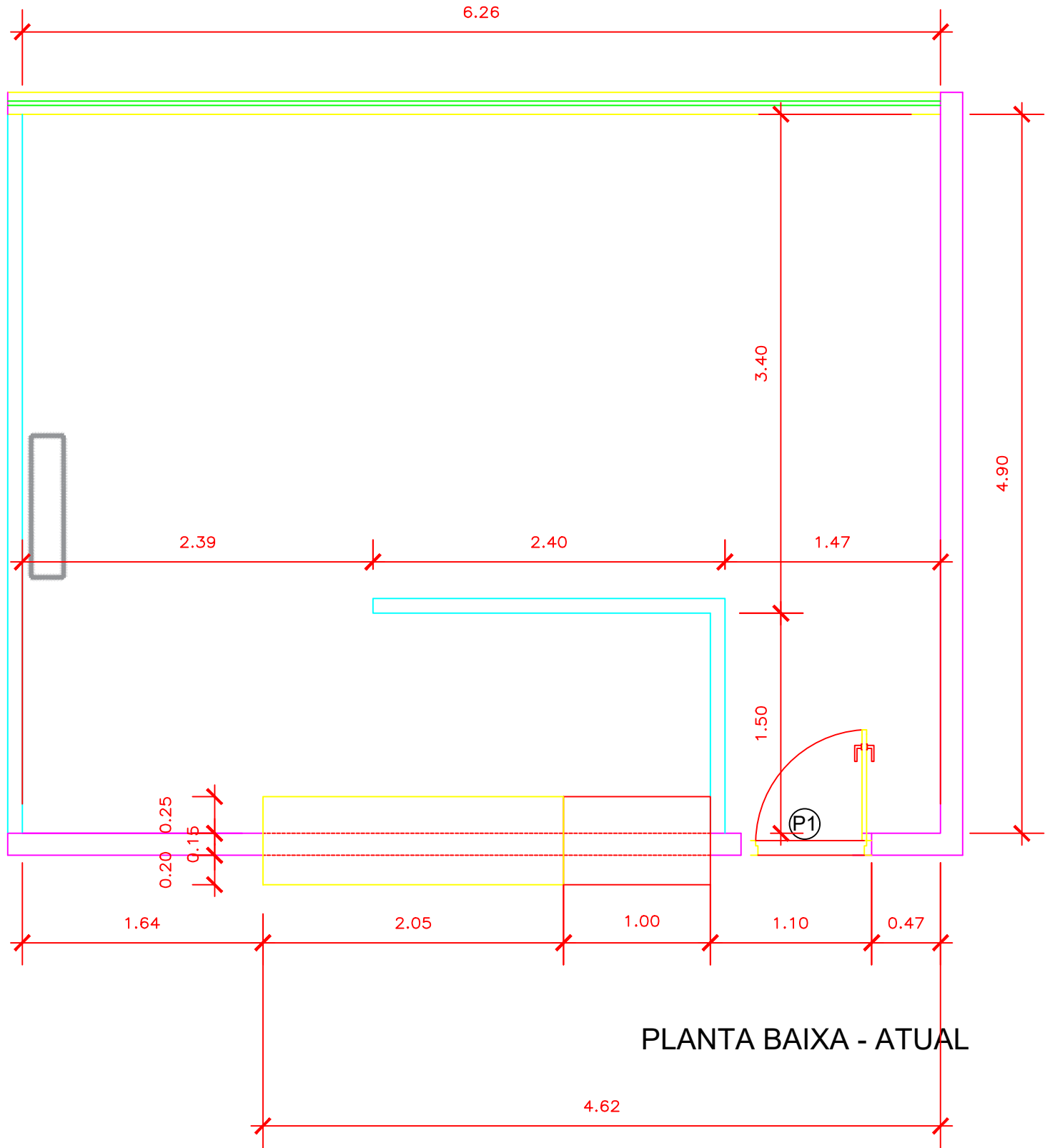

PLANTA BAIXA - ATUAL

OBS: CONFERIR MEDIDAS NO LOCAL

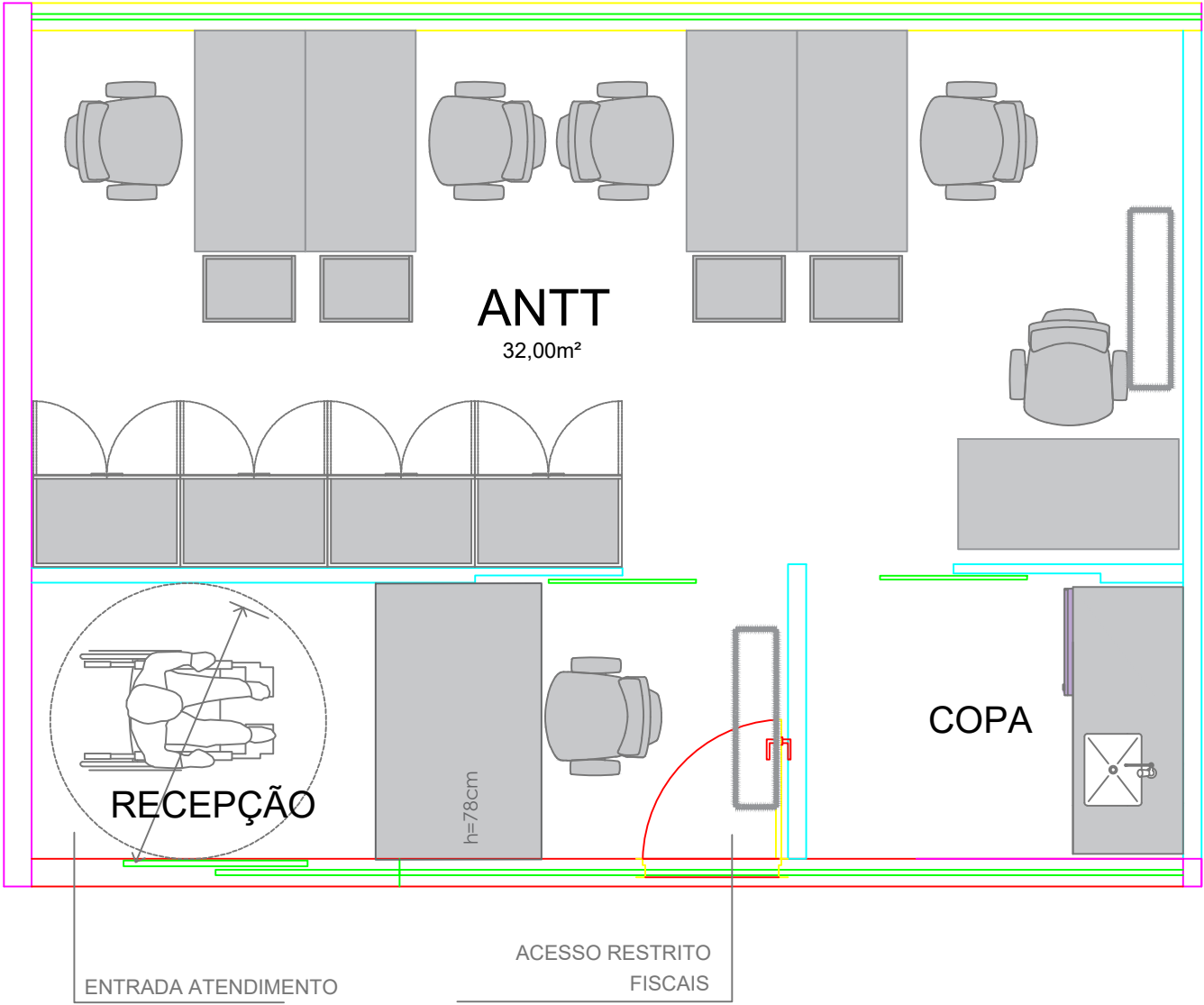

NOVO LAYOUT

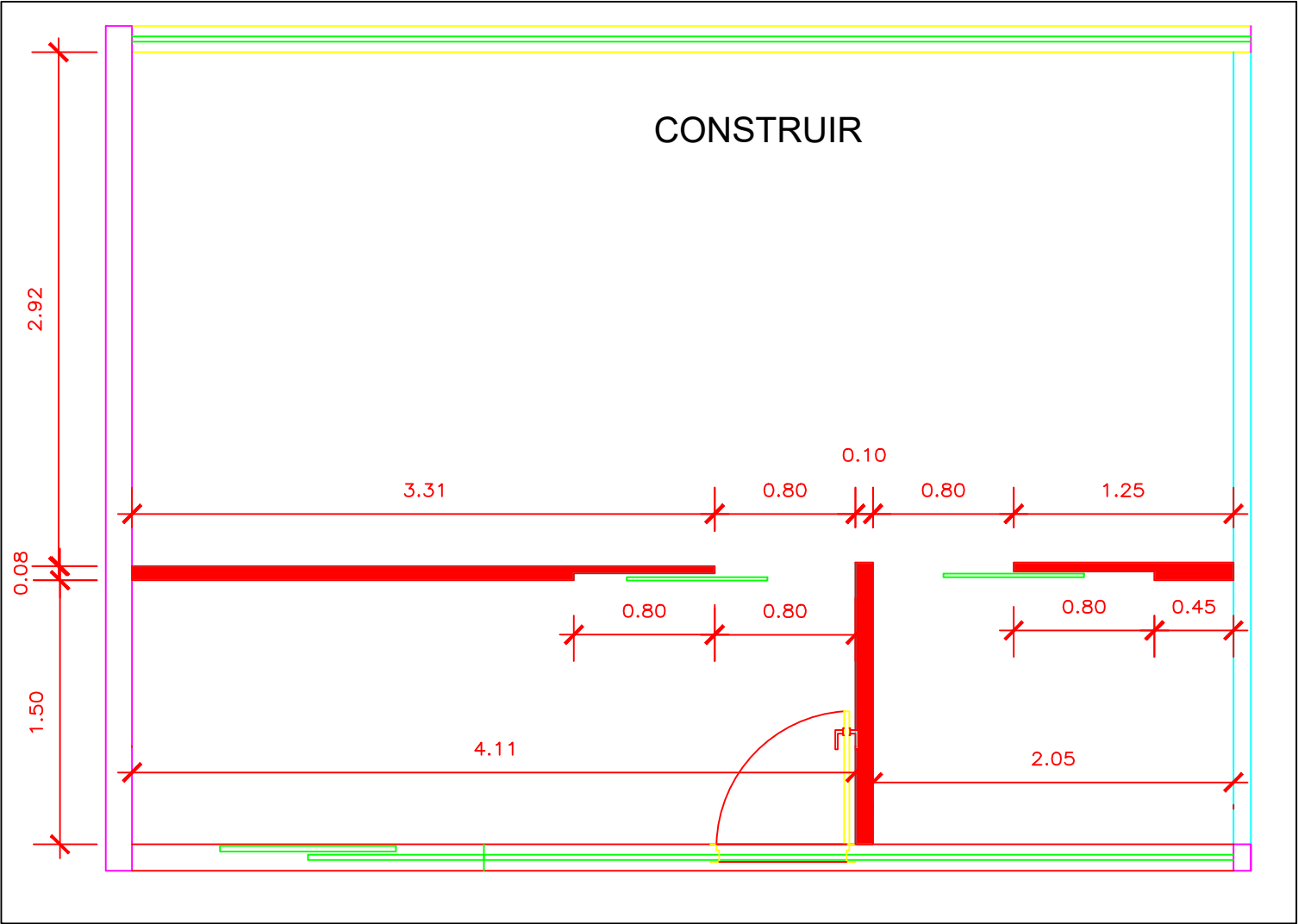
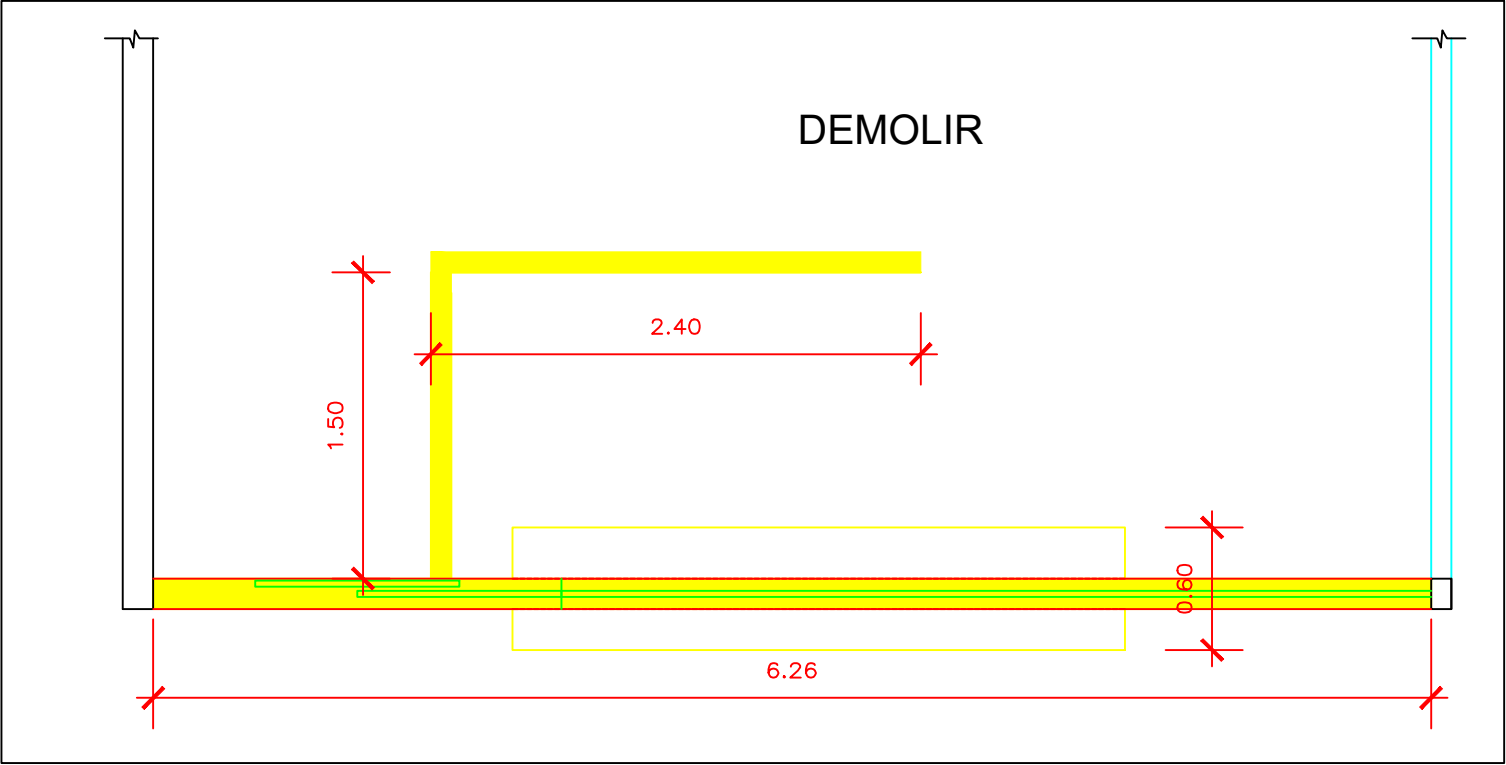

| LEGENDA |  |
|---------|--|
|         | DEMOLIR                                |
|         | CONSTRUIR - PAREDE DE GESSO EM DRYWALL |

DEMOLIR/CONSTRUIR

OBS: CONFERIR MEDIDAS NO LOCAL

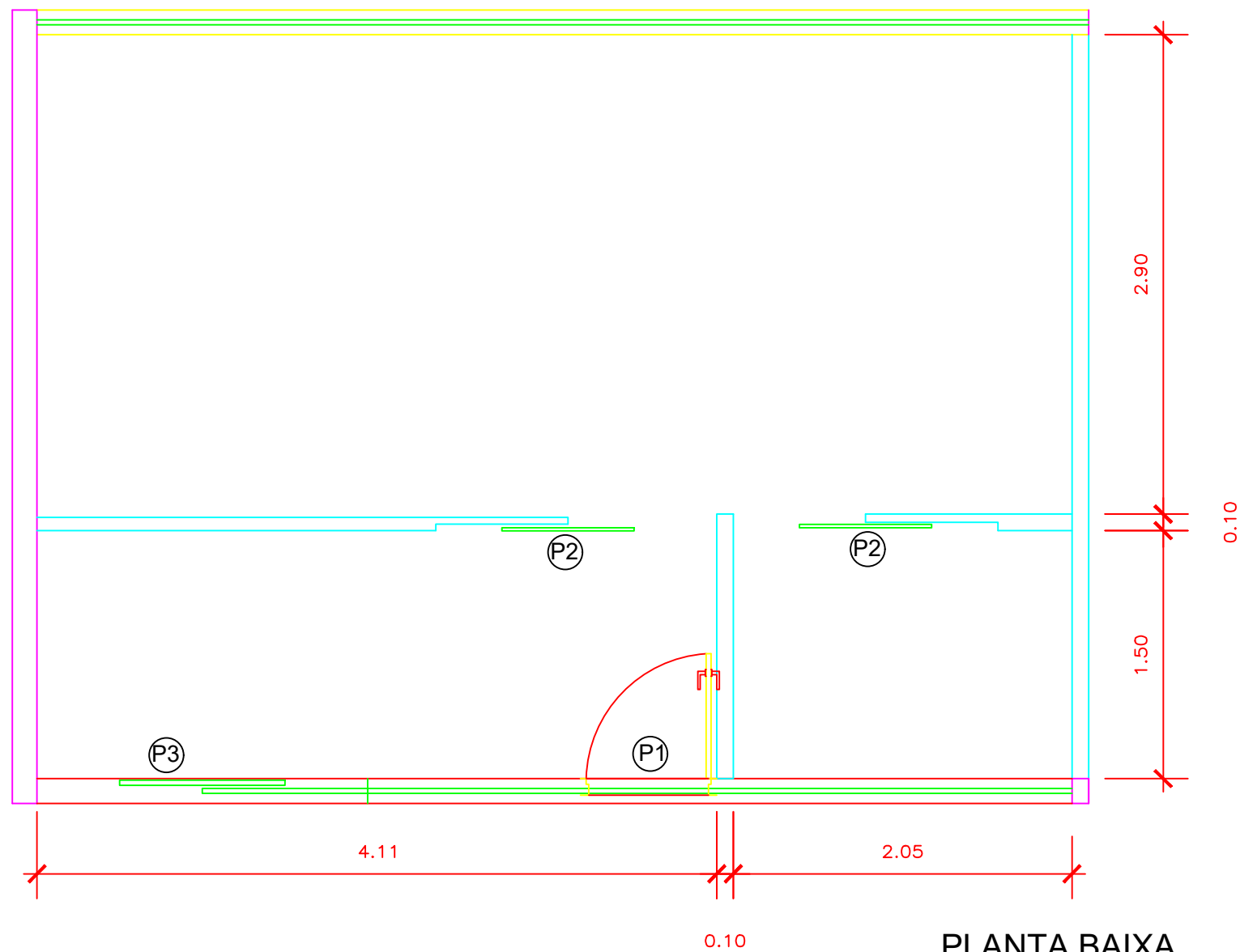

| ITEM. | ESQUADRIAS                          | QUANT. |
|-------|-------------------------------------|--------|
| P1    | Porta de giro em vidro 0,80x2,10m   | 1      |
| P2    | Porta de correr em vidro 0,80x2,10m | 2      |
| P3    | Porta de correr em vidro 1,00x2,10m | 1      |

OBS: CONFERIR MEDIDAS NO LOCAL

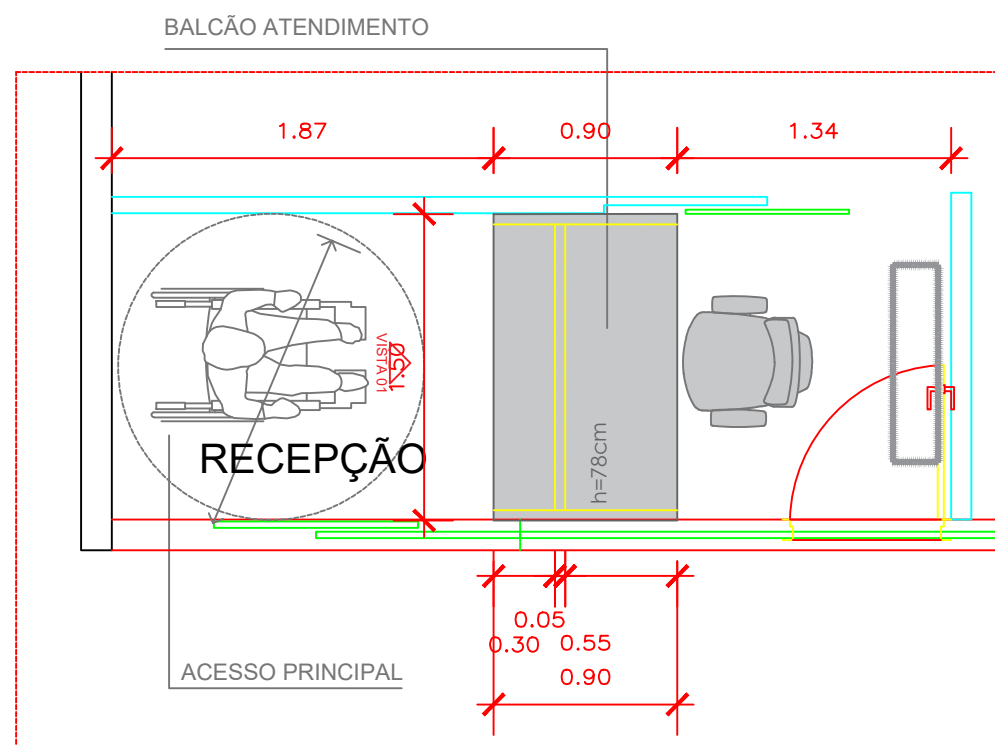

DET - BALCÃO ATENDIMENTO

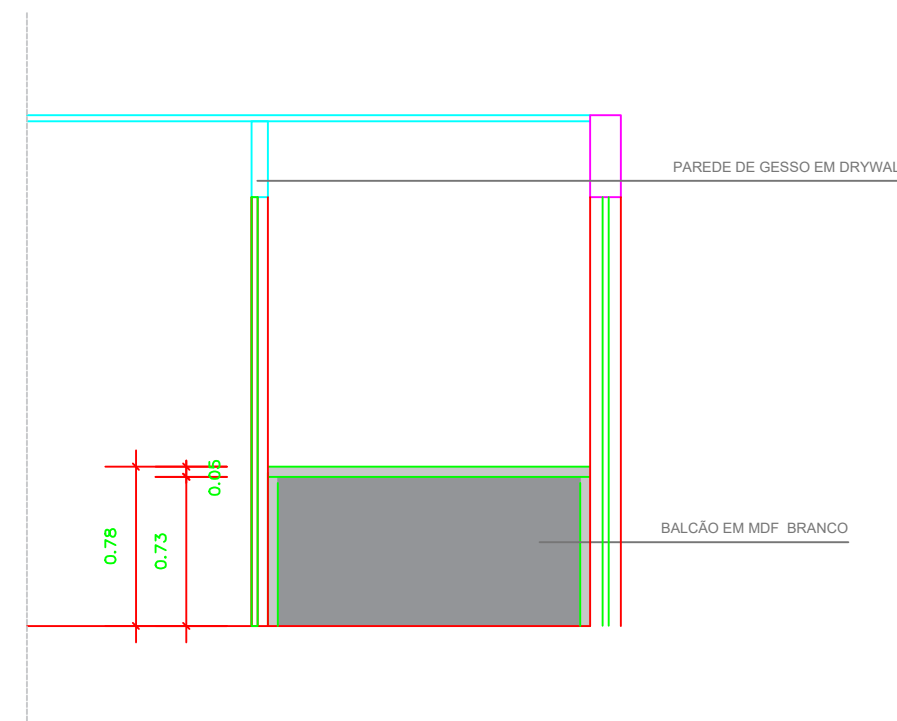

BALCÃO ATENDIMENTO - VISTA 01

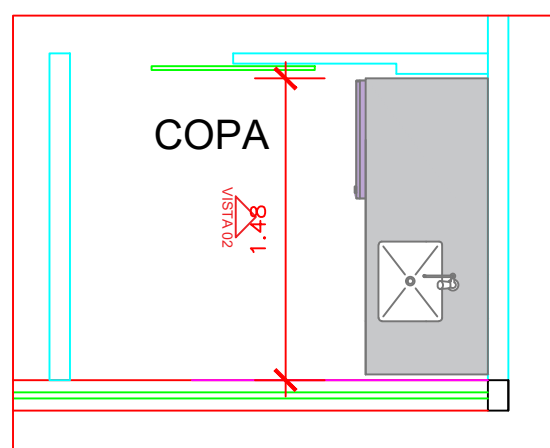

DET - COPA

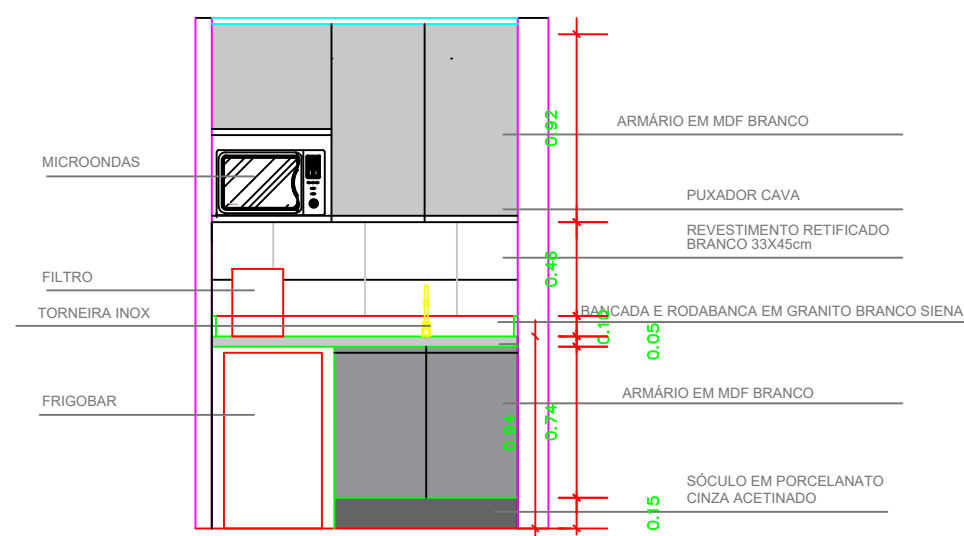

COPA - VISTA 02

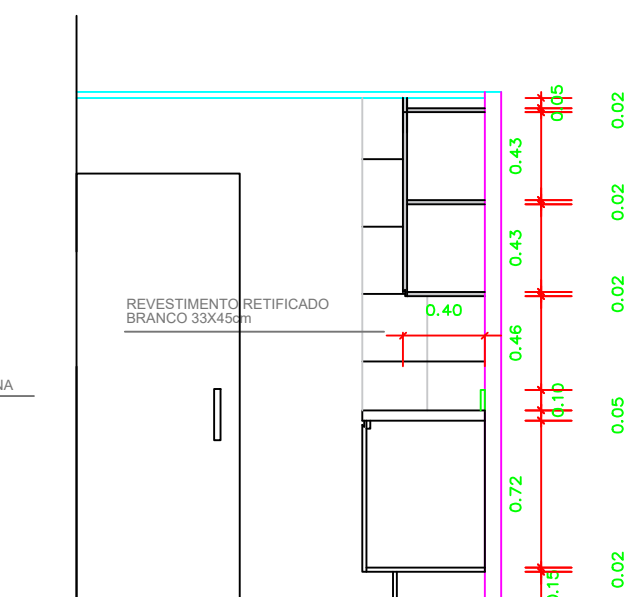

CORTE COPA

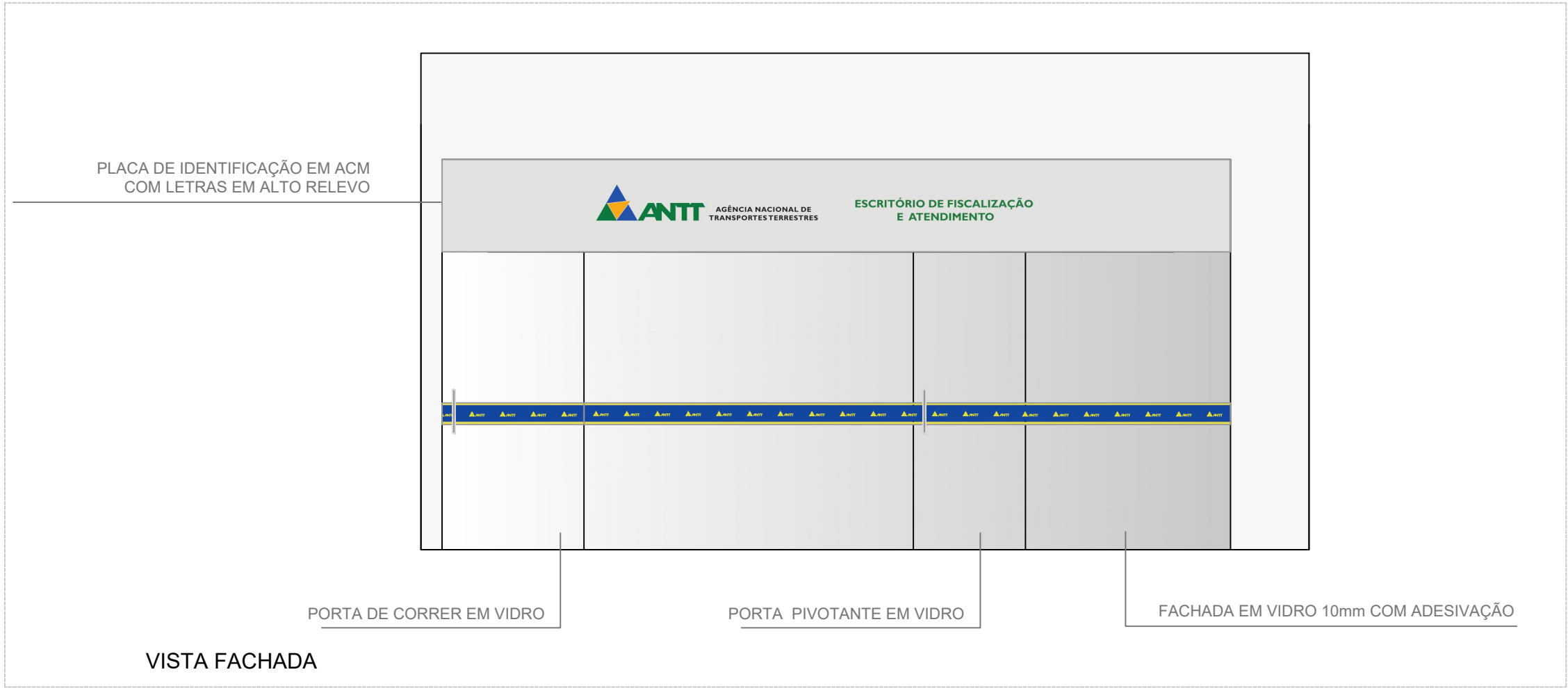

OBS: CONFERIR MEDIDAS NO LOCAL

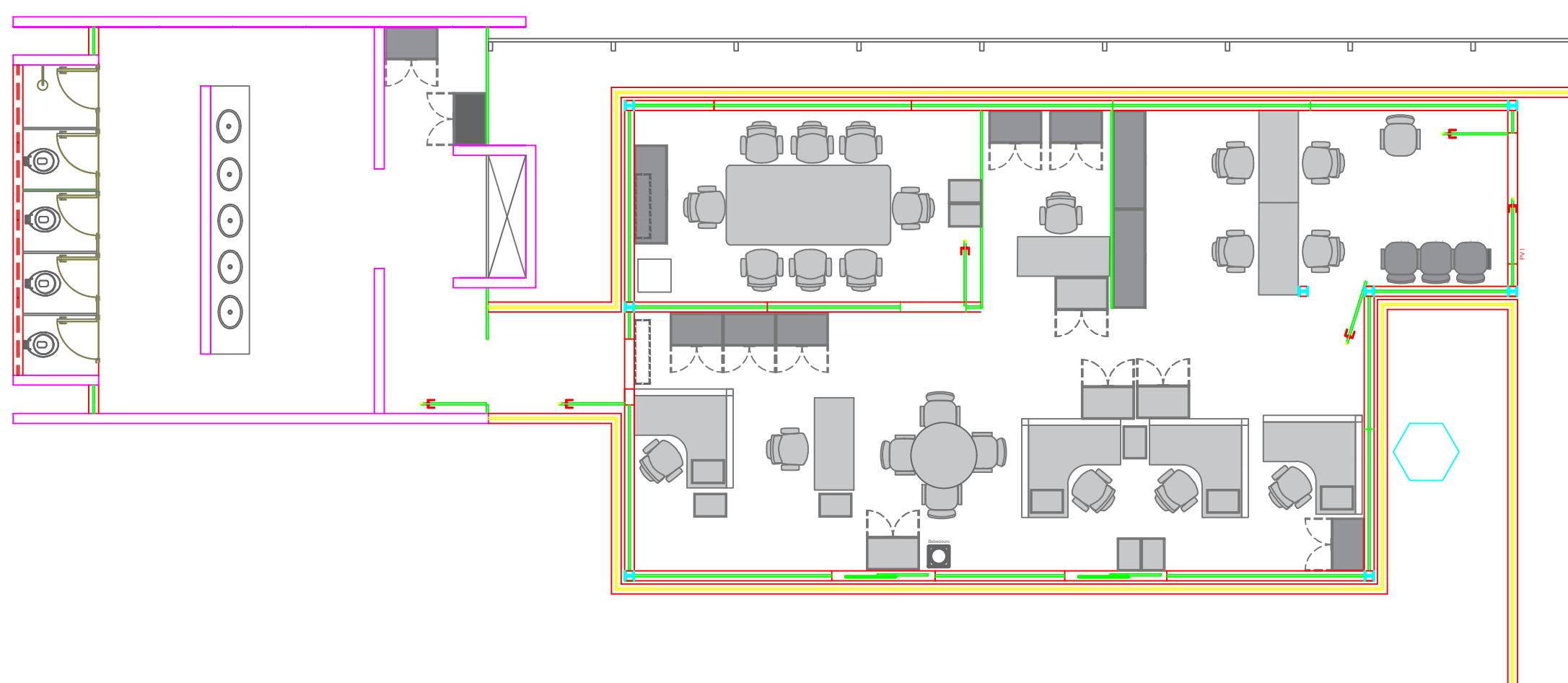

LAYOUT ATUAL

OBS: CONFERIR MEDIDAS NO LOCAL





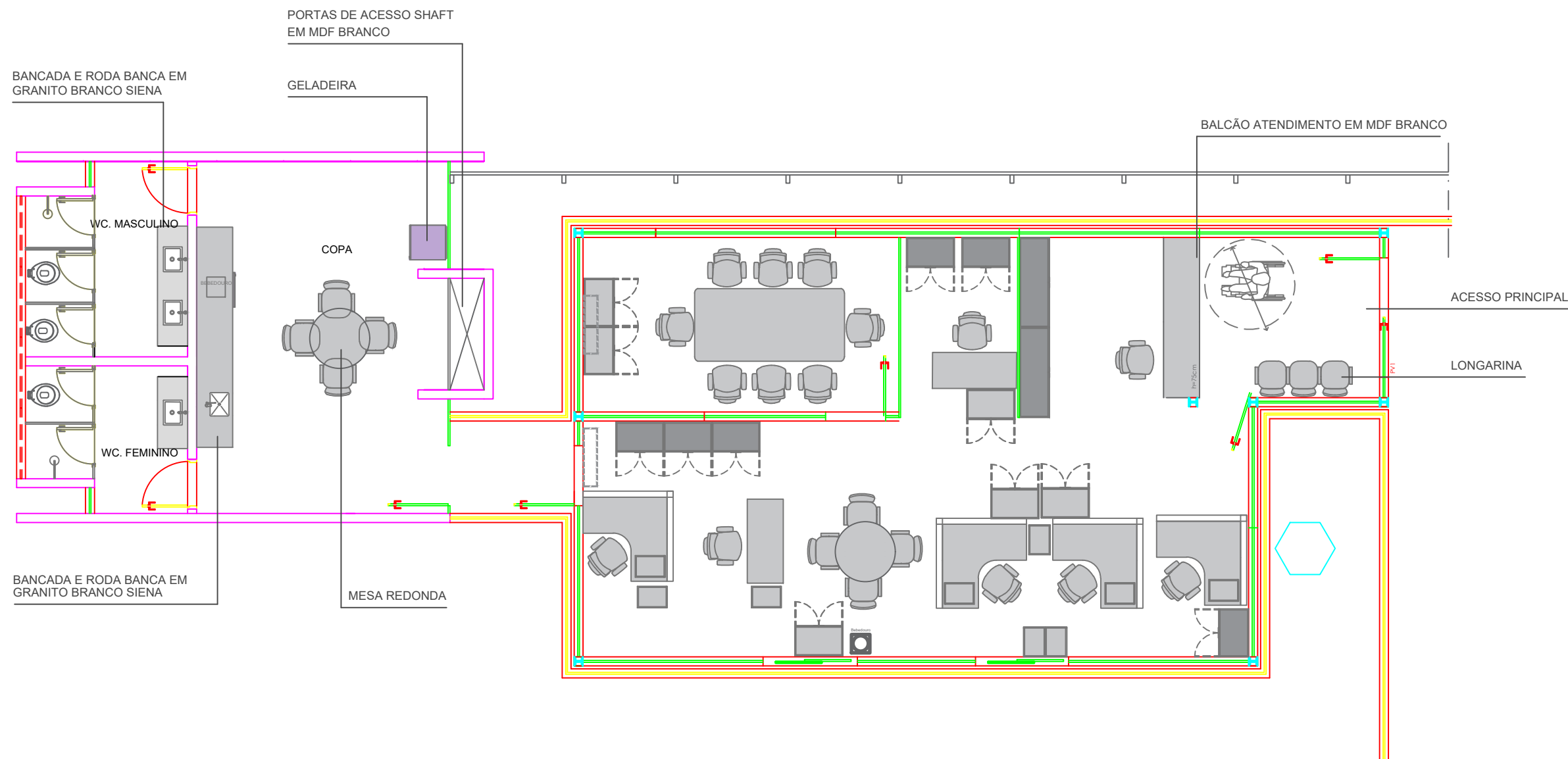

NOVO LAYOUT

OBS: CONFERIR MEDIDAS NO LOCAL

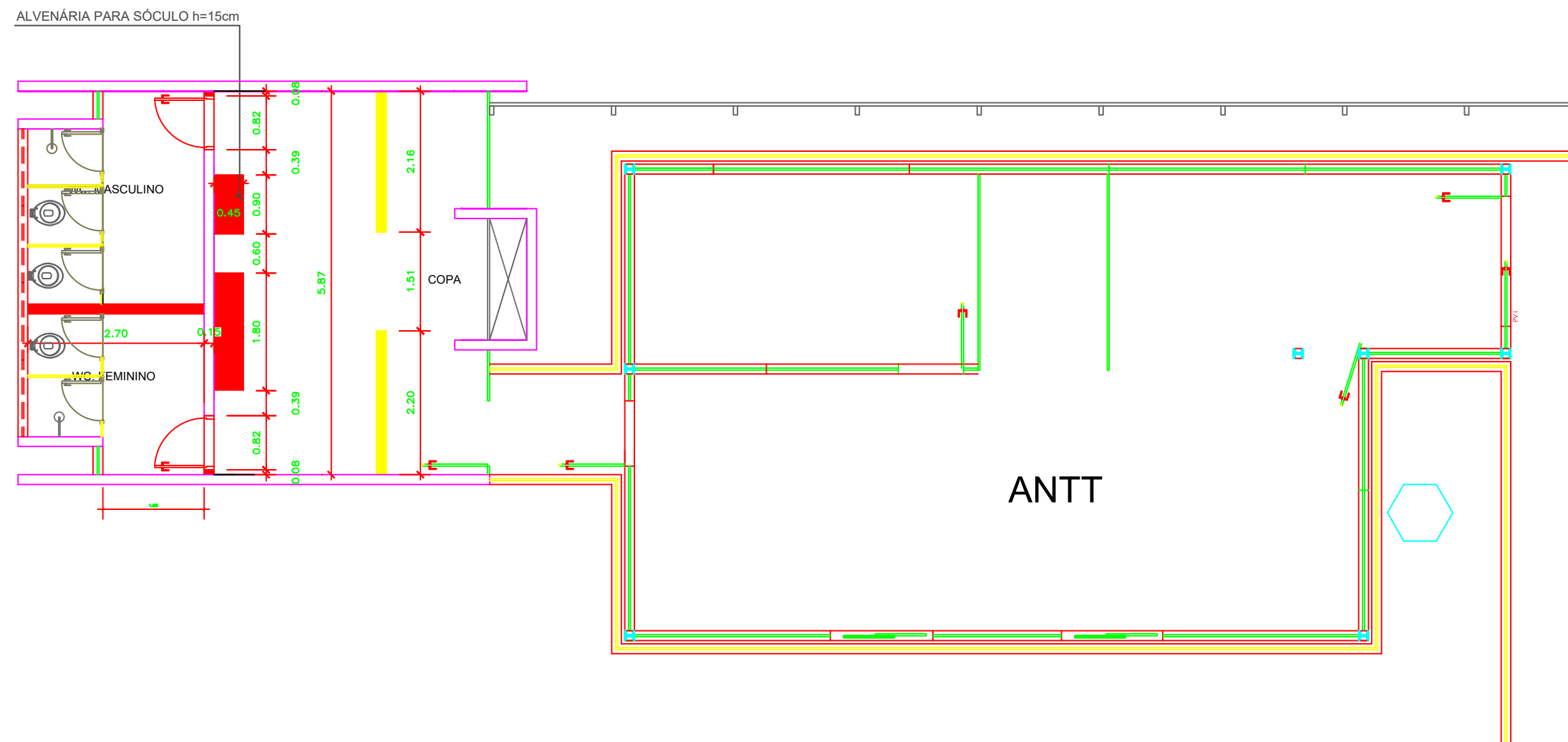

| LEGENDA  |   |
|--|---|
| <span style="background-color: yellow; border: 1px solid black; display: inline-block; width: 15px; height: 10px;"></span> | DEMOLIR   |
| <span style="background-color: red; border: 1px solid black; display: inline-block; width: 15px; height: 10px;"></span>    | CONSTRUIR - PAREDE COM PLACA DE GESSO HIDROFUGADA |

DEMOLIR/CONSTRUIR

OBS: CONFERIR MEDIDAS NO LOCAL

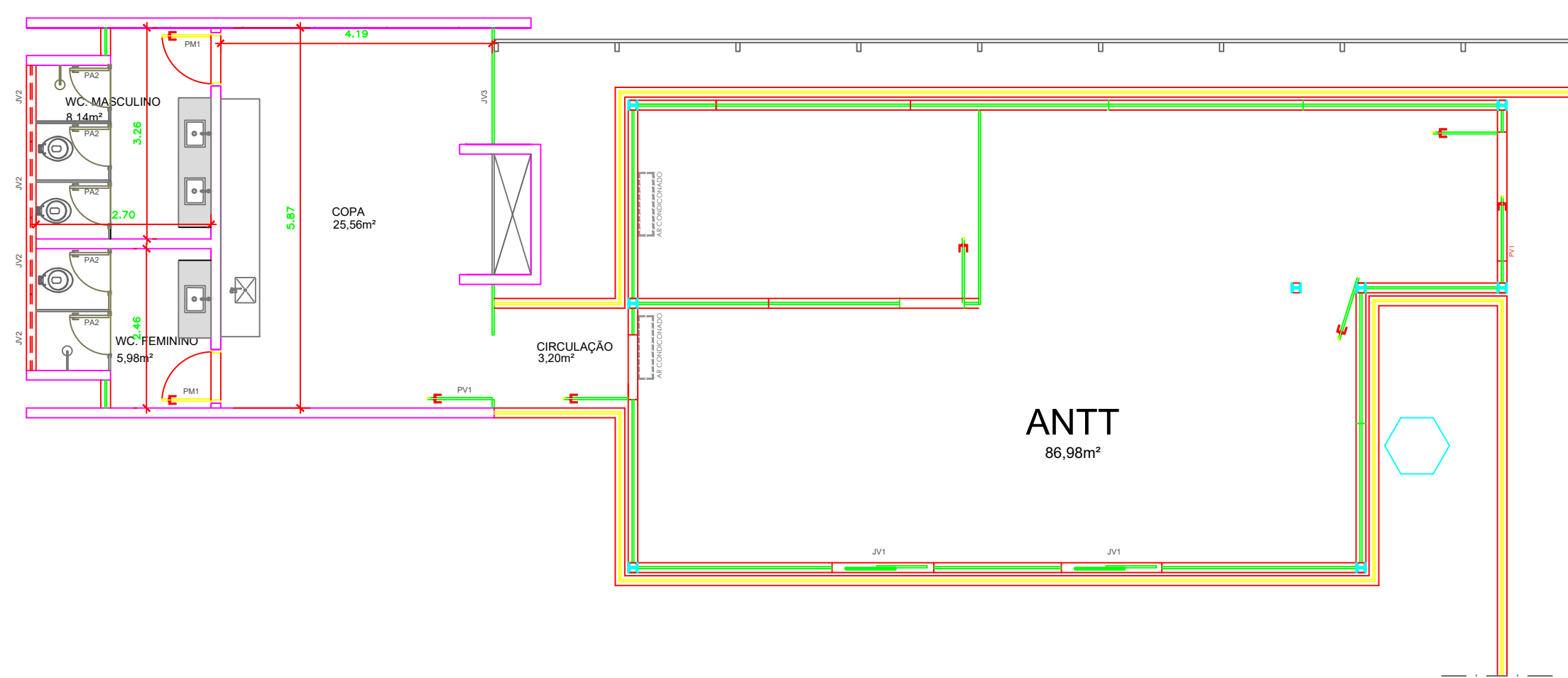

| QUANT. | ESQUADRIAS  |
|--------|---|
| 2      | PM1 - Porta de madeira 0,80X2,10m                       |
| 1      | PV1 - Porta em vidro 1,00X2,10m                         |
| 5      | PA2 - Porta de alumínio para box de banheiro 0,55x1,80m |
| 2      | JV1 - Janela de correr em vidro 1,50X1,00m              |
| 1      | JV2 - Janela alta basculante em vidro (vão 4,74x0,60m)  |
| 1      | JV3 - Janela basculante em vidro (vão 1,88x0,88m)       |

EXECUTIVO

OBS: CONFERIR MEDIDAS NO LOCAL

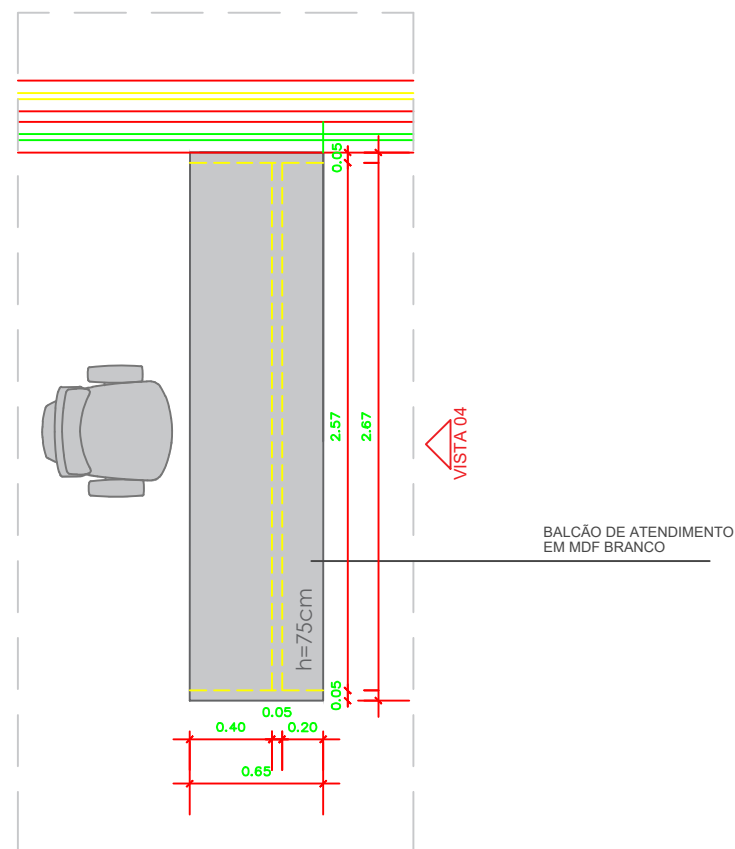

BALCÃO ATENDIMENTO  
VISTA SUPERIOR

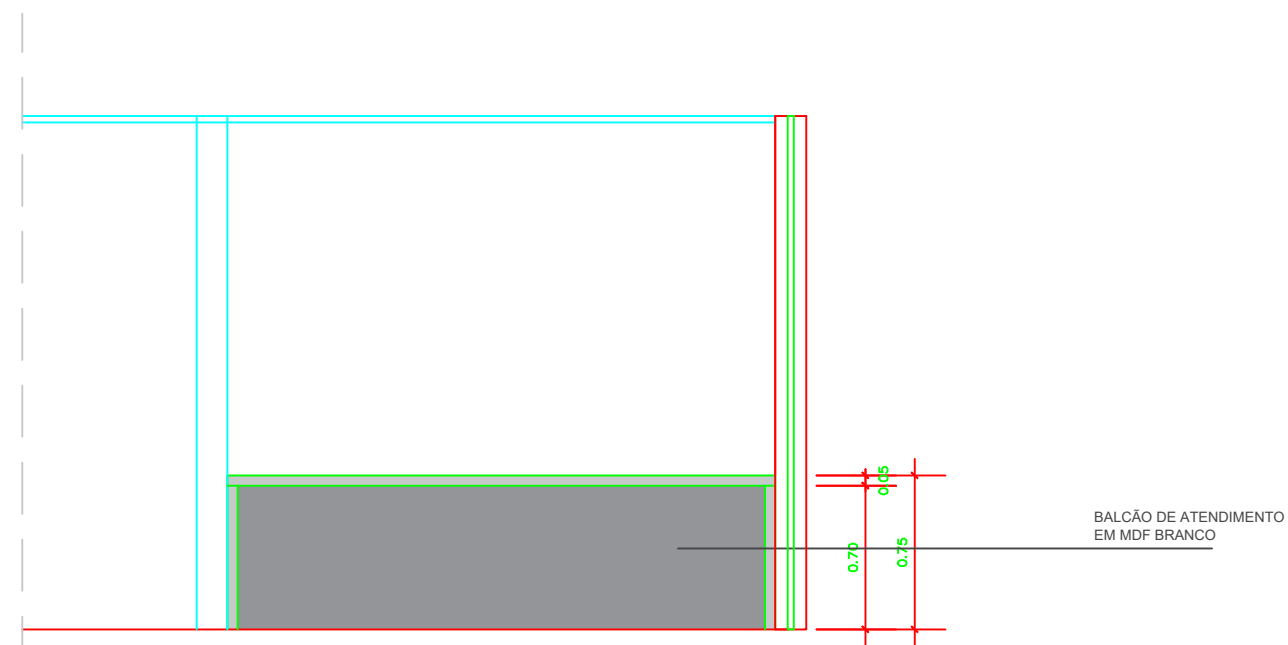

VISTA 04

OBS: CONFERIR MEDIDAS NO LOCAL

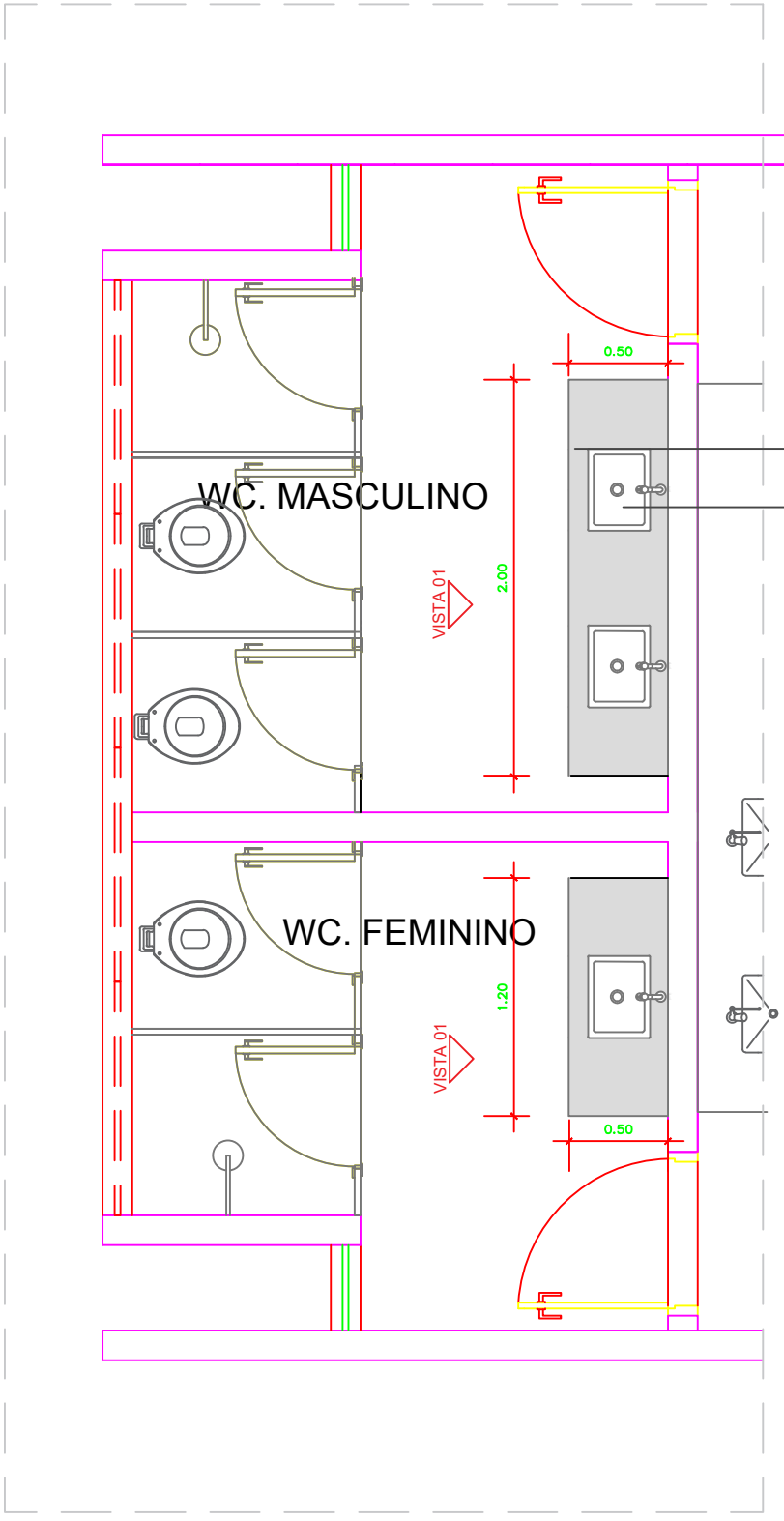

BANCADA E RODA BANCA EM  
GRANITO BRANCO SIENA

CUBA DE EMBUTIR EM LOUÇA  
QUADRADA BRANCA

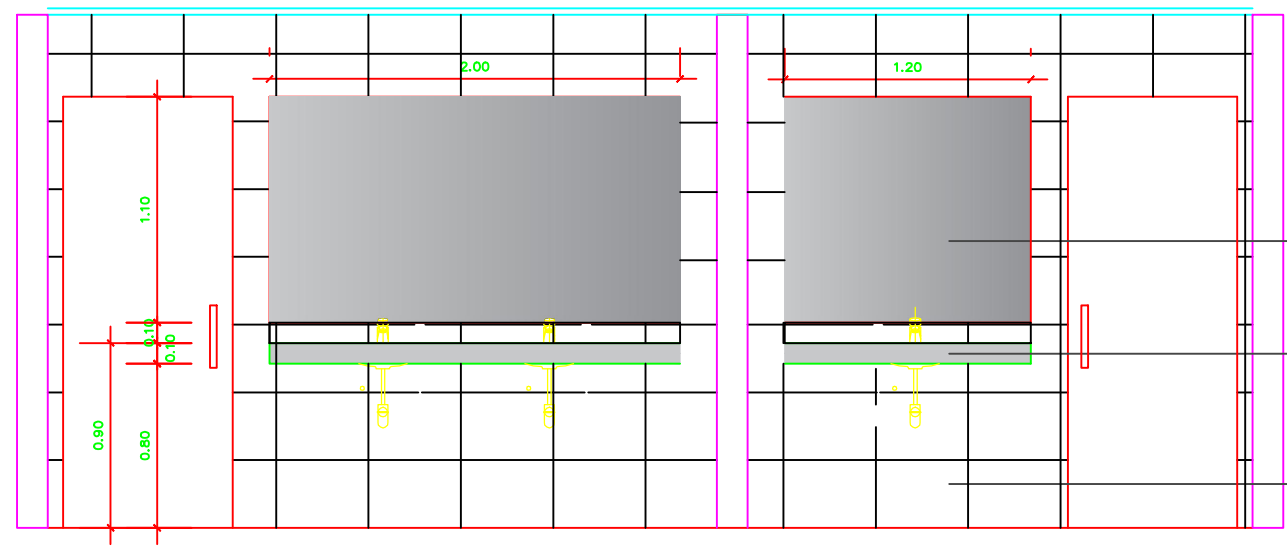

ESPELHO

BANCADA E RODA BANCA EM  
GRANITO BRANCO SIENA

REVESTIMENTO RETIFICADO  
BRANCO 33x45cm

VISTA 01

OBS: CONFERIR MEDIDAS NO LOCAL

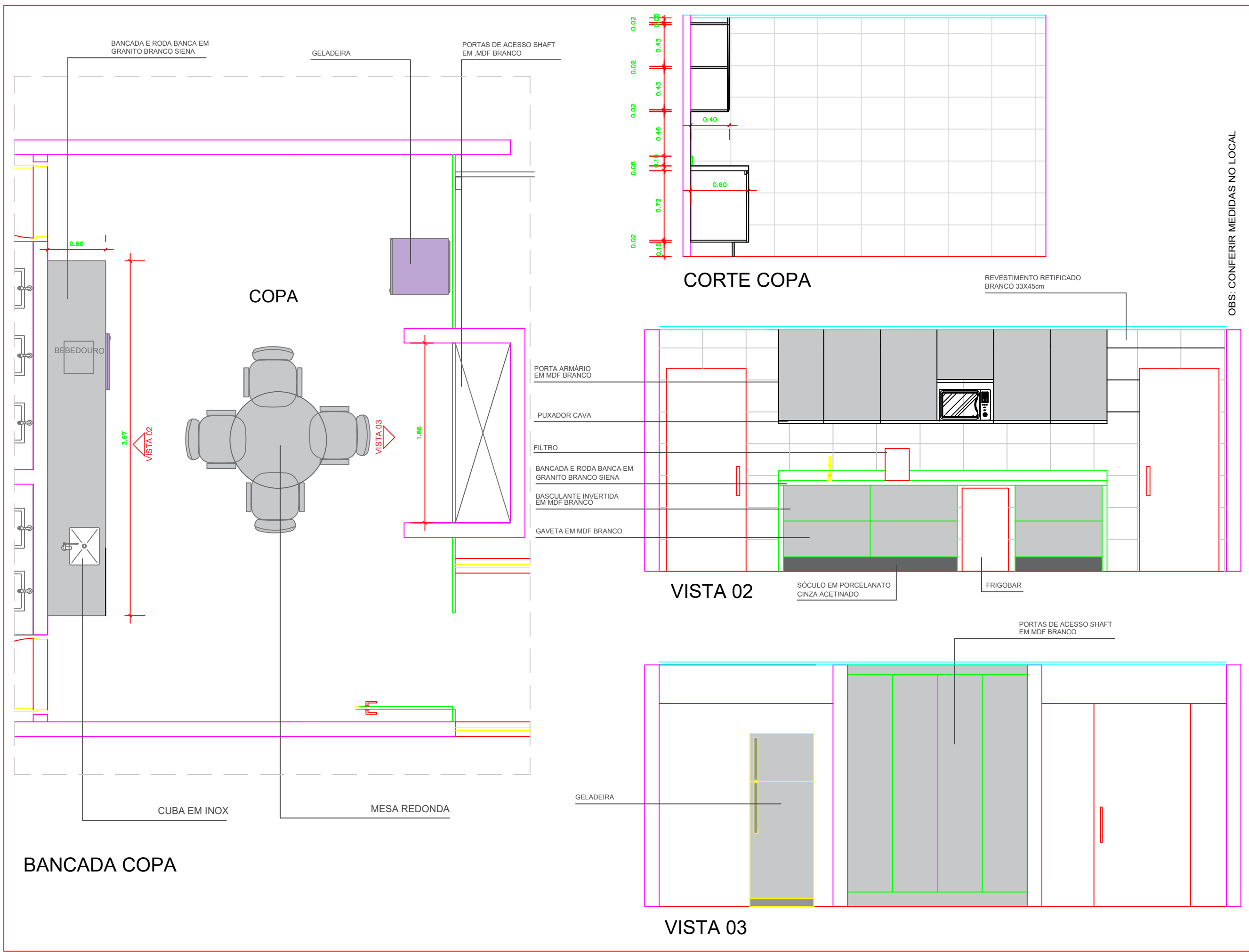

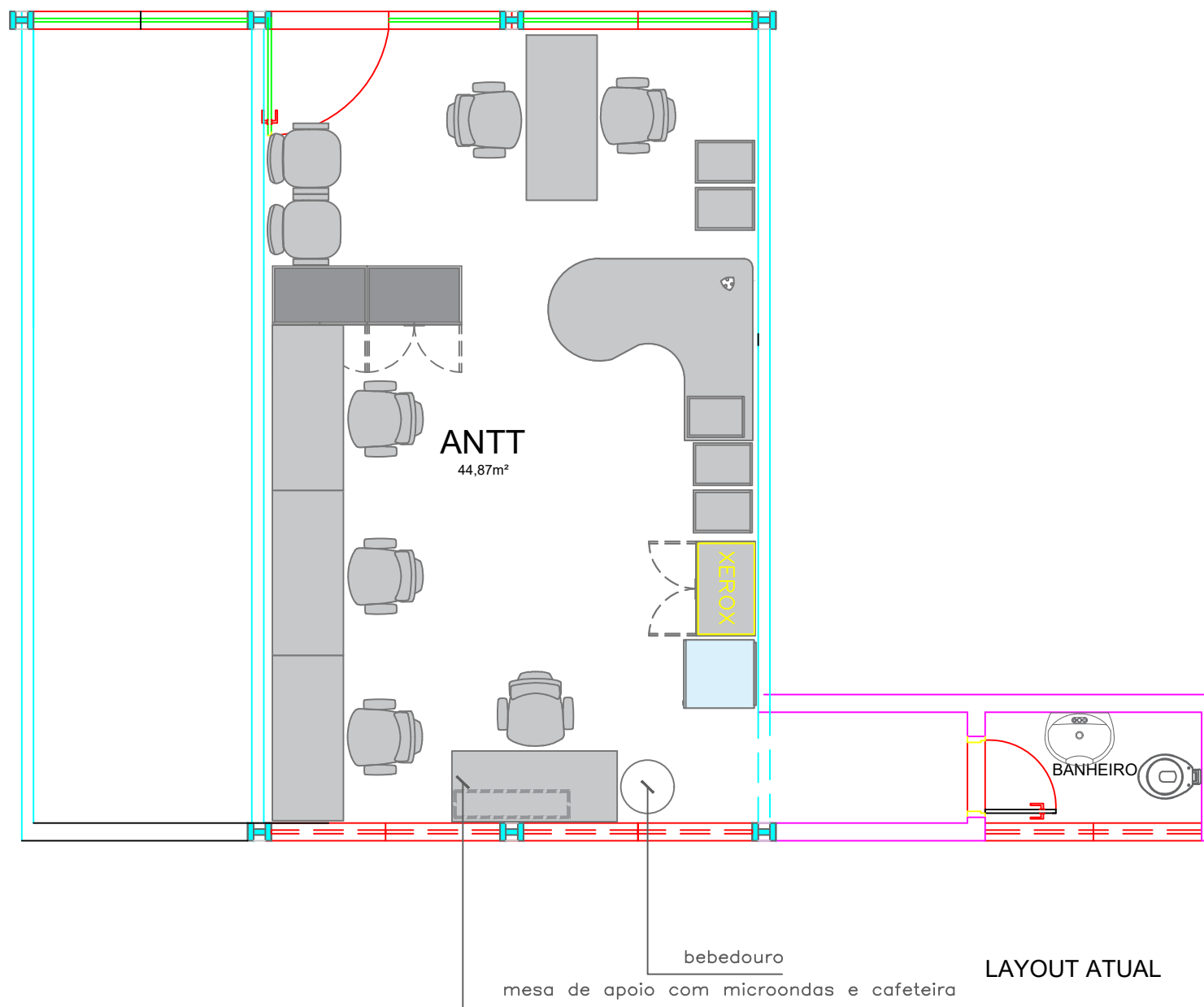

OBS: CONFERIR MEDIDAS NO LOCAL

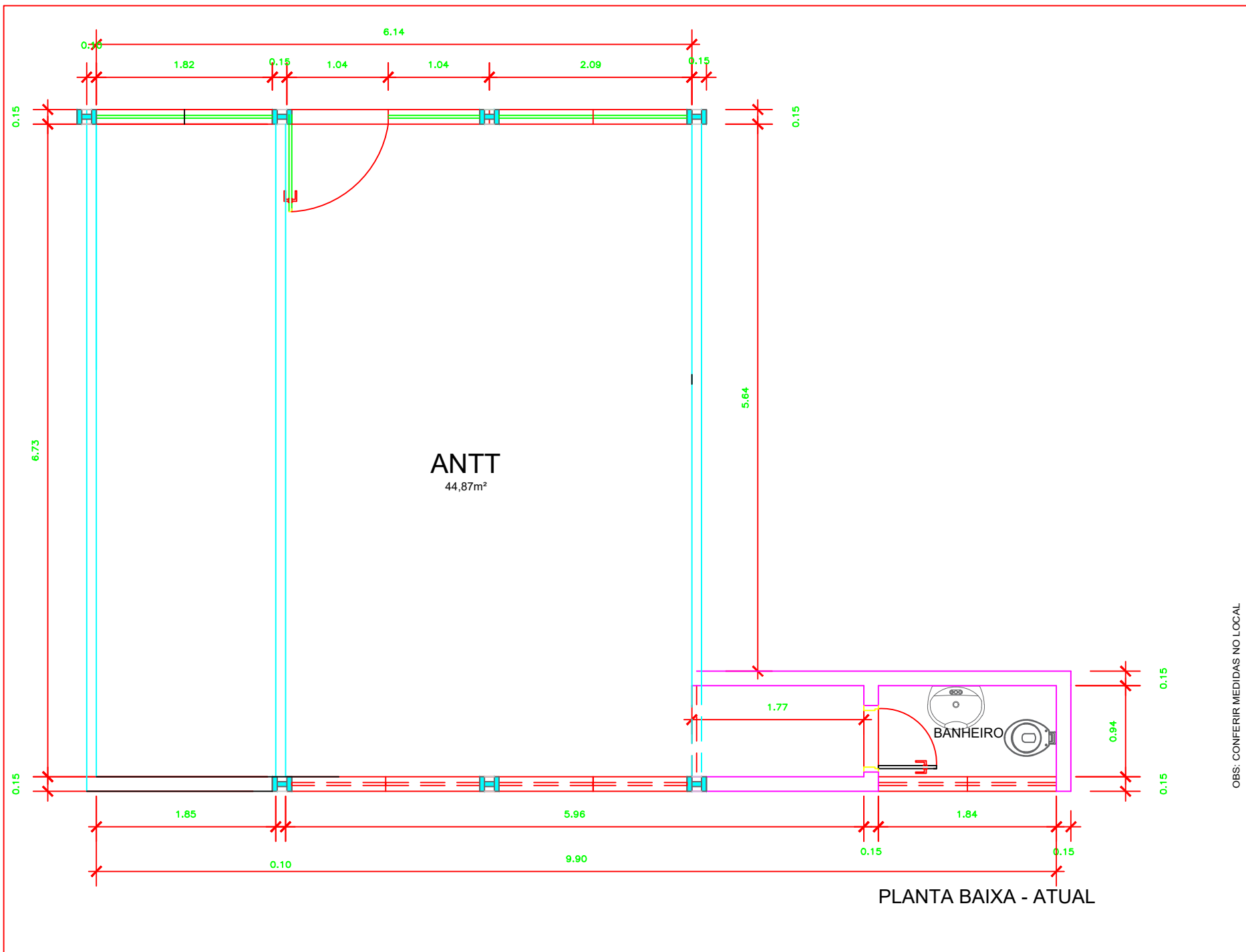

# RODOVIÁRIA INTERESTADUAL BELO HORIZONTE - MG



ASSUNTO: POSTO DA RODOVIÁRIA INTERESTADUAL - MG  
TIPO: PLANTA BAIXA  
AUTOR: GELOG - ANTT  
REVISÃO: REV 00

DATA: 02/04/2025  
ESCALA:  
PROJETO: BRENDA LIM  
PROJETO: MARLUCIO CHAGAS

PRONOME

02/07



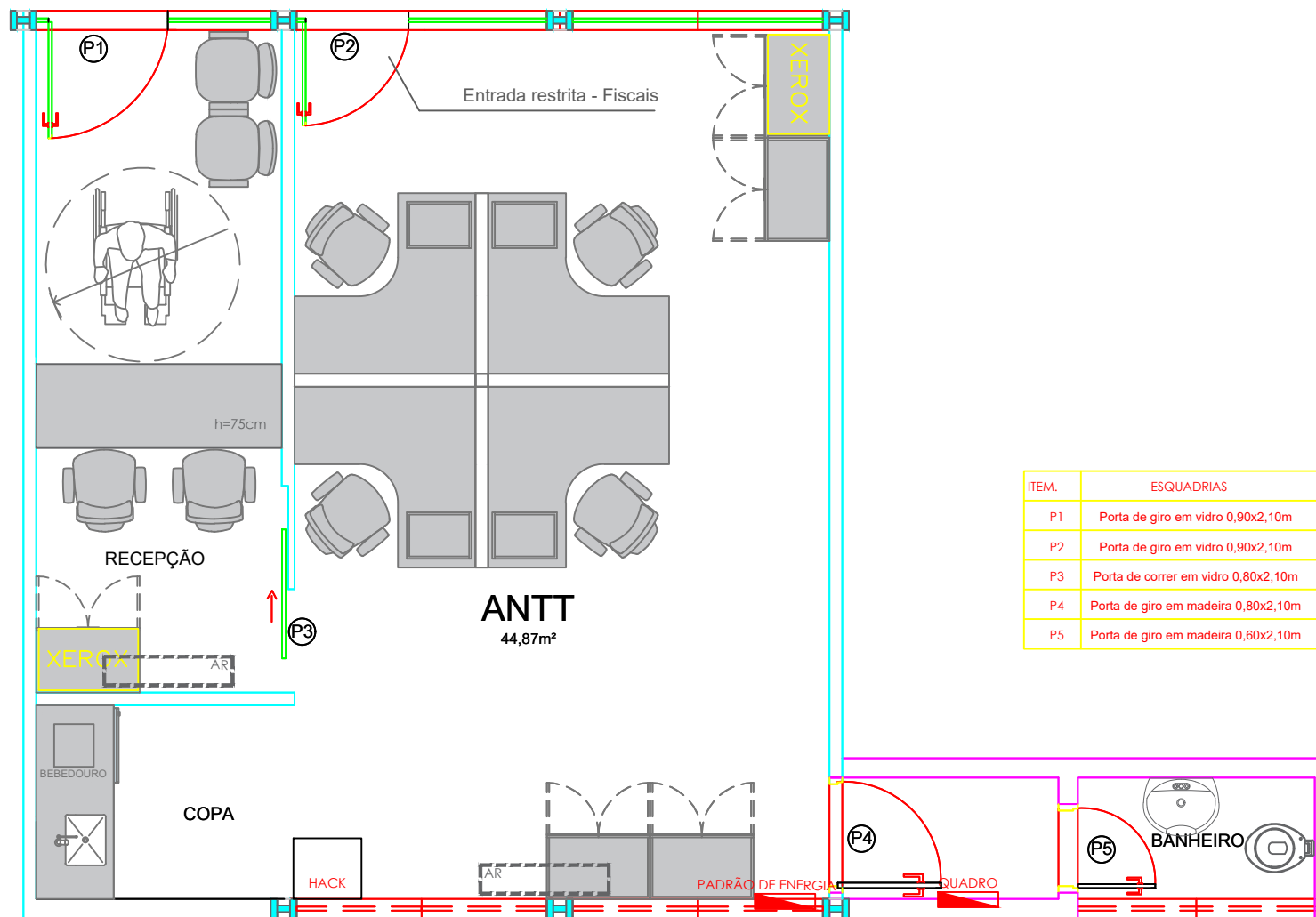

| ITEM. | ESQUADRIAS                          | QUANT. |
|-------|-------------------------------------|--------|
| P1    | Porta de giro em vidro 0,90x2,10m   | 1      |
| P2    | Porta de giro em vidro 0,90x2,10m   | 1      |
| P3    | Porta de correr em vidro 0,80x2,10m | 1      |
| P4    | Porta de giro em madeira 0,80x2,10m | 1      |
| P5    | Porta de giro em madeira 0,60x2,10m | 1      |

OBS: CONFERIR MEDIDAS NO LOCAL

NOVO LAYOUT

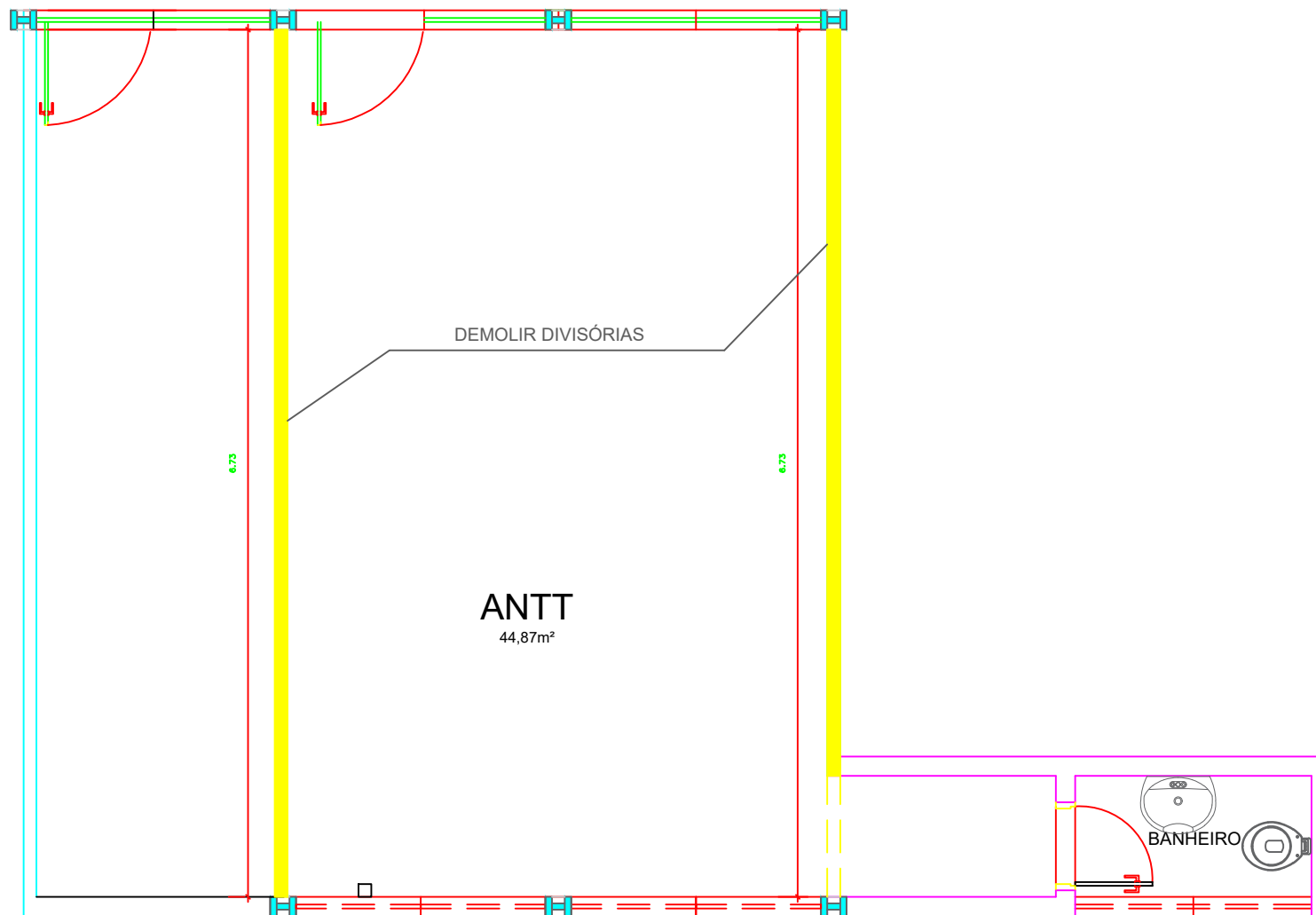

ANTT  
44,87m²

DEMOLIR DIVISÓRIAS

BANHEIRO

| LEGENDA  |           |
|--|-----------|
| <span style="background-color: yellow; border: 1px solid black; display: inline-block; width: 15px; height: 10px;"></span> | DEMOLIR   |
| <span style="background-color: red; border: 1px solid black; display: inline-block; width: 15px; height: 10px;"></span>    | CONSTRUIR |

DEMOLIR

OBS: CONFERIR MEDIDAS NO LOCAL

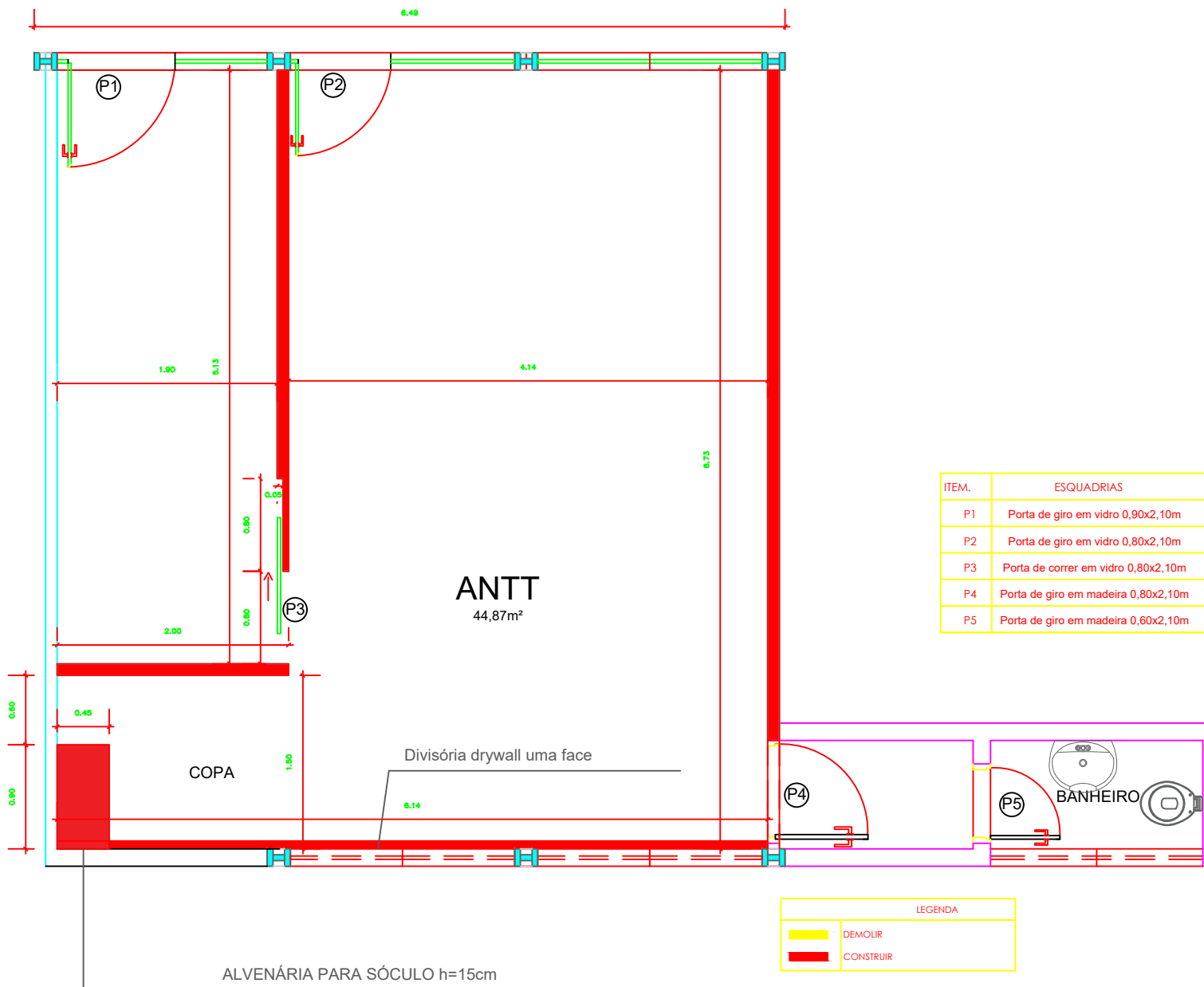

OBS: CONFERIR MEDIDAS NO LOCAL

| LEGENDA  |           |
|--|-----------|
| <span style="background-color: yellow; border: 1px solid black; display: inline-block; width: 20px; height: 10px;"></span> | DEMOLIR   |
| <span style="background-color: red; border: 1px solid black; display: inline-block; width: 20px; height: 10px;"></span>    | CONSTRUIR |

CONSTRUIR / EXECUTIVO

RODOVIÁRIA INTERESTADUAL  
BELO HORIZONTE - MG



ASSUNTO: POSTO DA RODOVIÁRIA INTERESTADUAL - MG  
TIPO: EXECUTIVO  
AUTOR: GELOG - ANTT  
REVISÃO: REV 00

DATA: 02/04/2025  
ESCALA:  
PROJETO: BRENDA LIM  
PROJETO: MARLUCIO CHAGAS

05/07

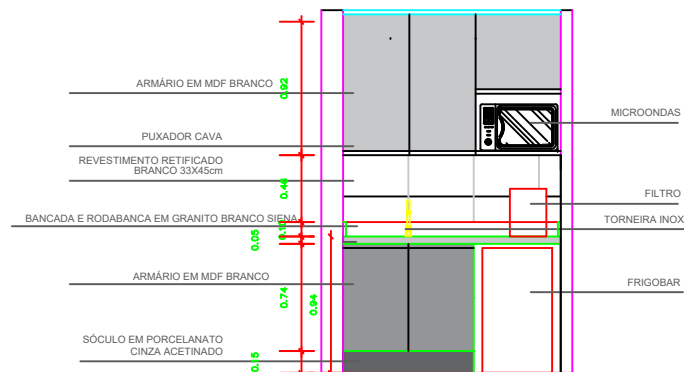
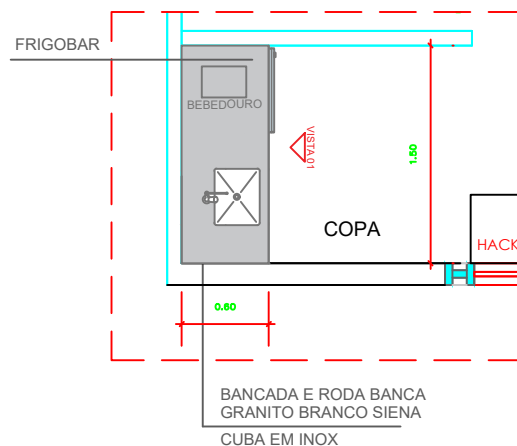

COPA - VISTA 01

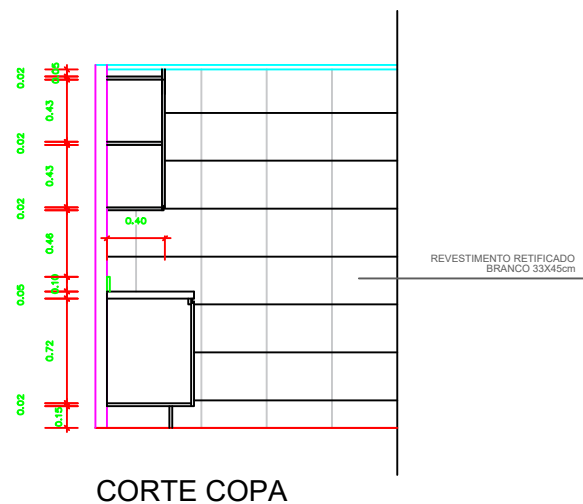

OBS: CONFERIR MEDIDAS NO LOCAL

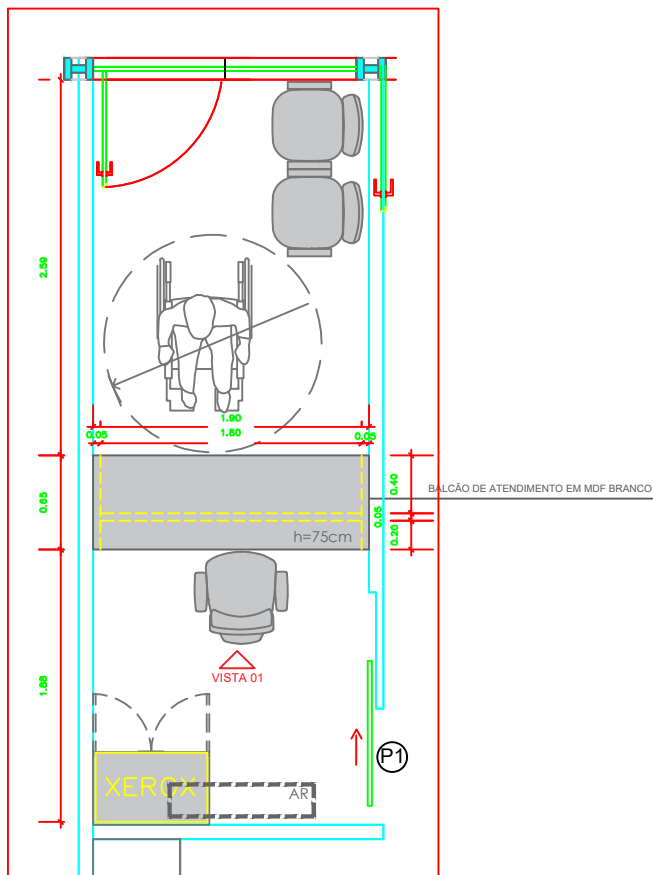

BALCÃO ATENDIMENTO

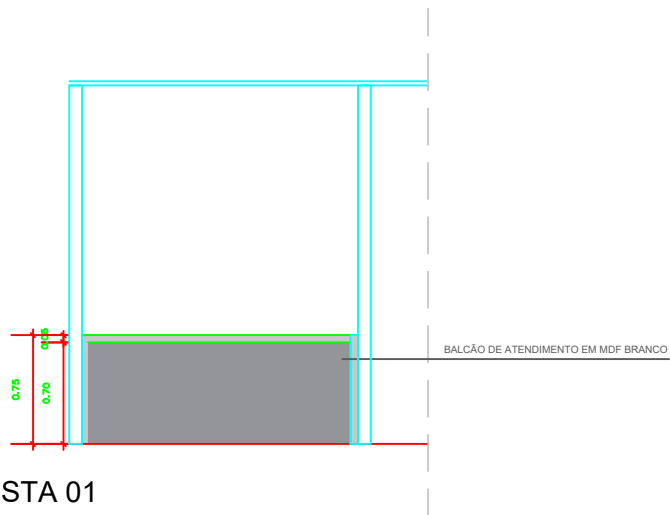

VISTA 01

OBIS: CONFERIR MEDIDAS NO LOCAL

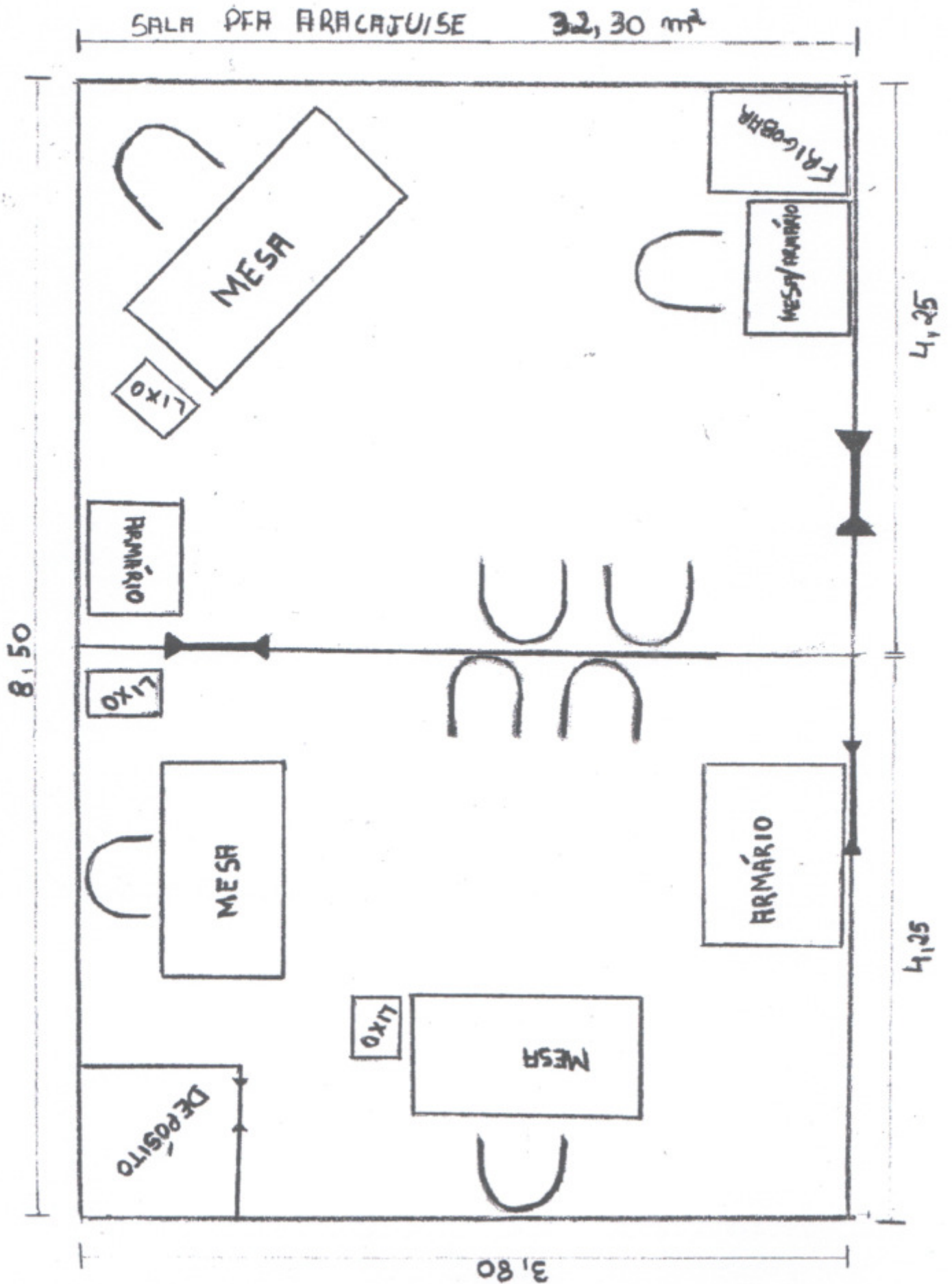

BEBEDOURO

AR CONDICIONADO

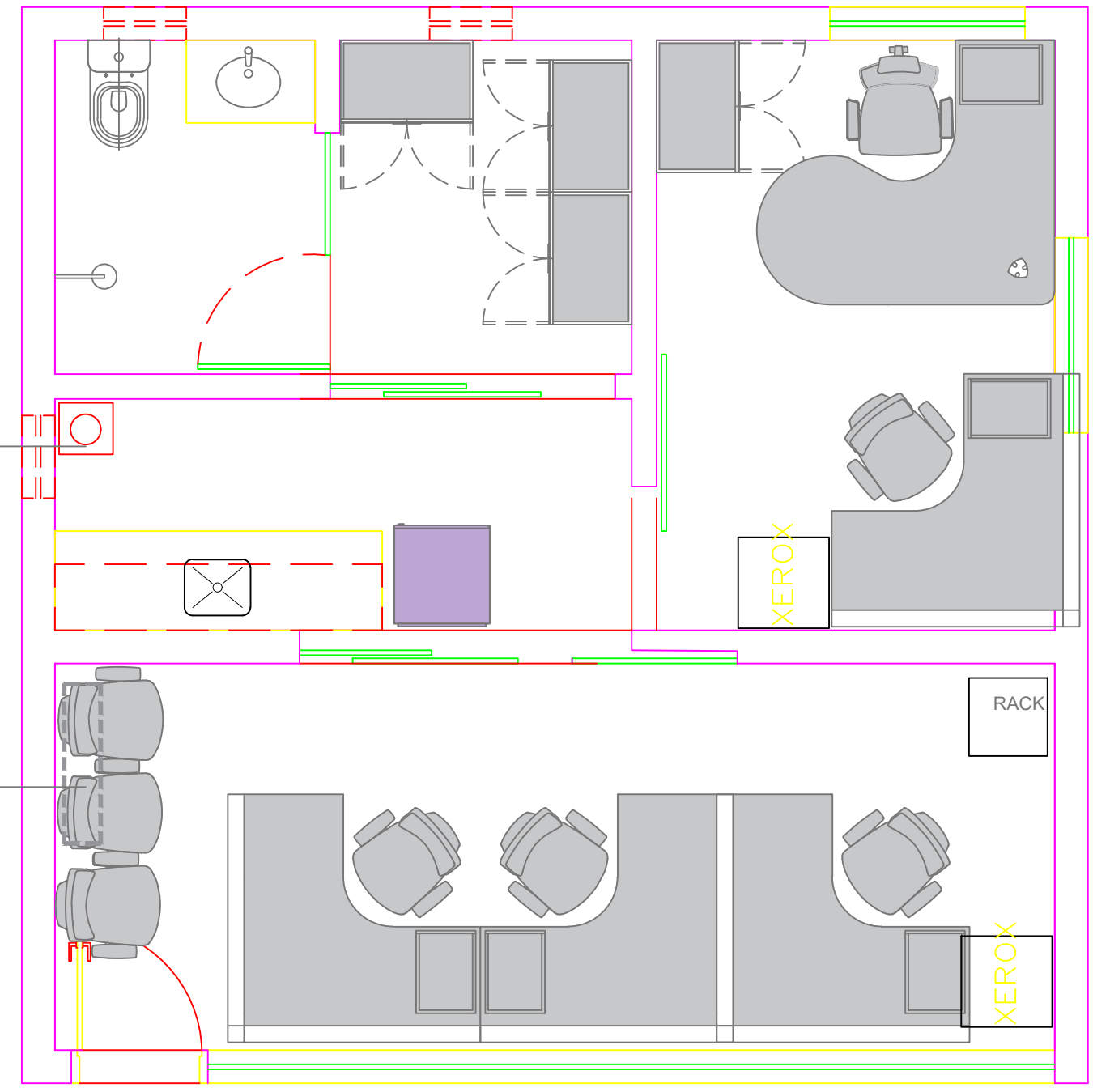

OBS: CONFERIR MEDIDAS NO LOCAL

LAYOUT ATUAL

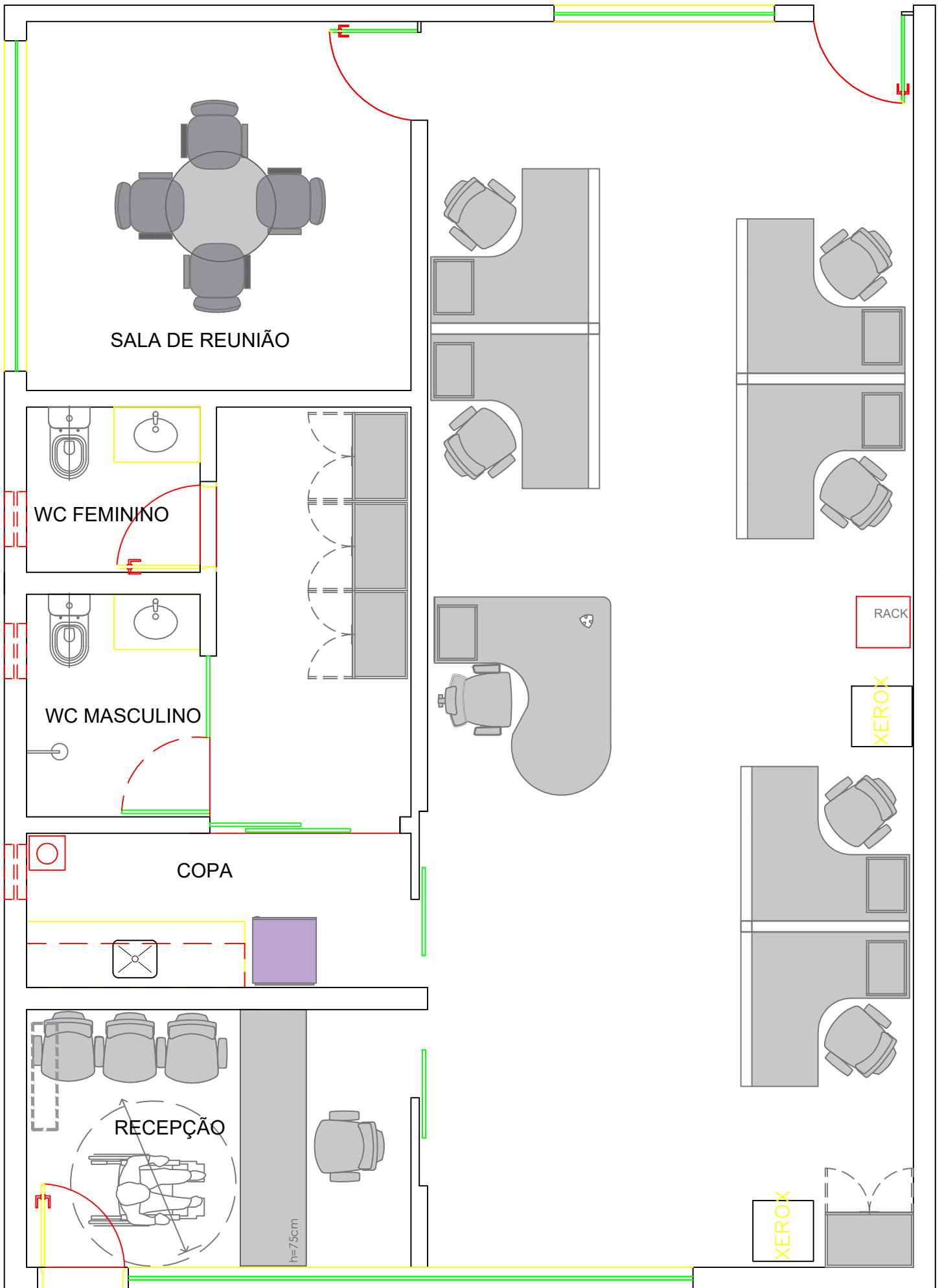



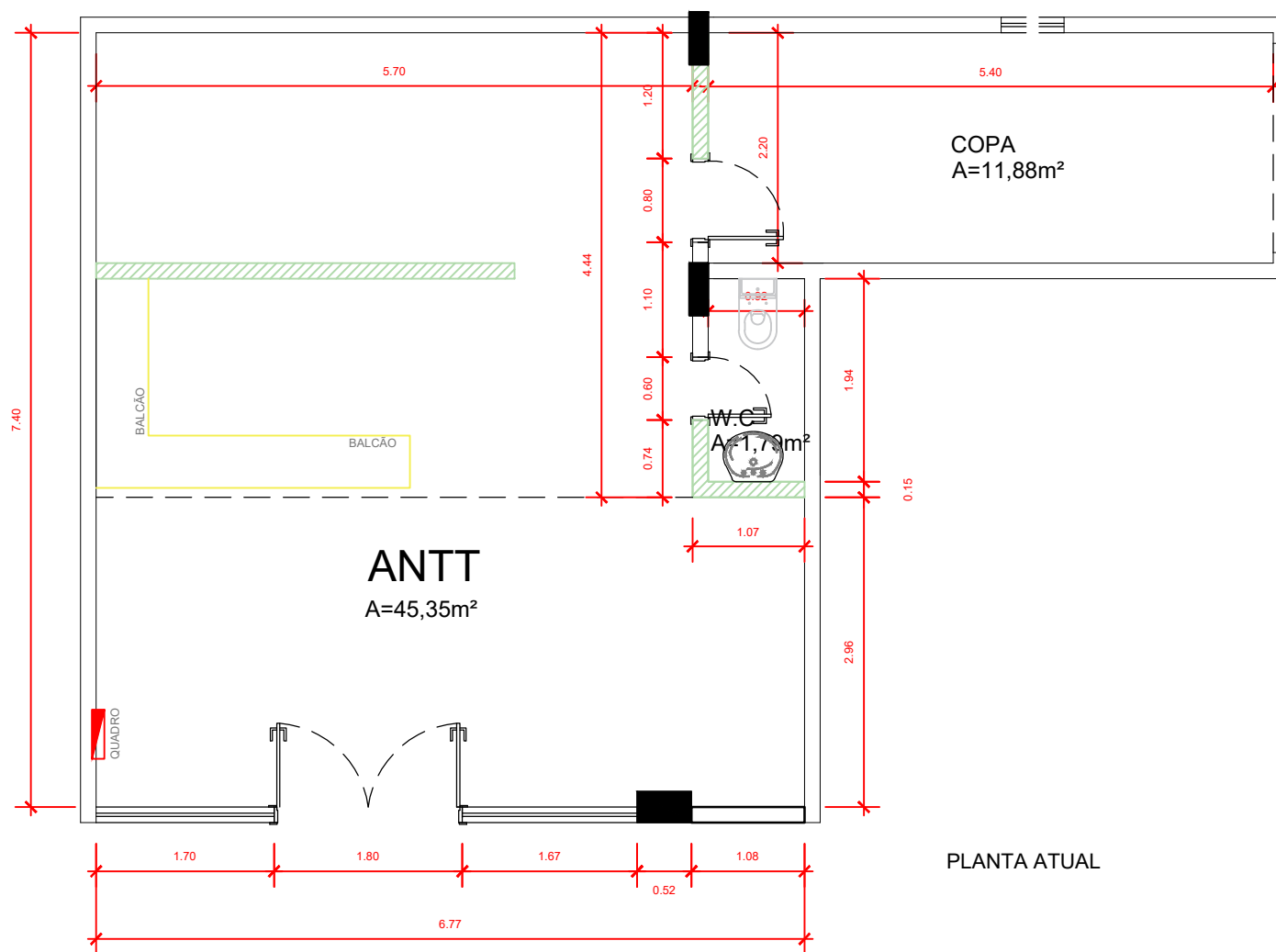

OBS: CONFERIR MEDIDAS NO LOCAL

OBS: CONFERIR MEDIDAS NO LOCAL

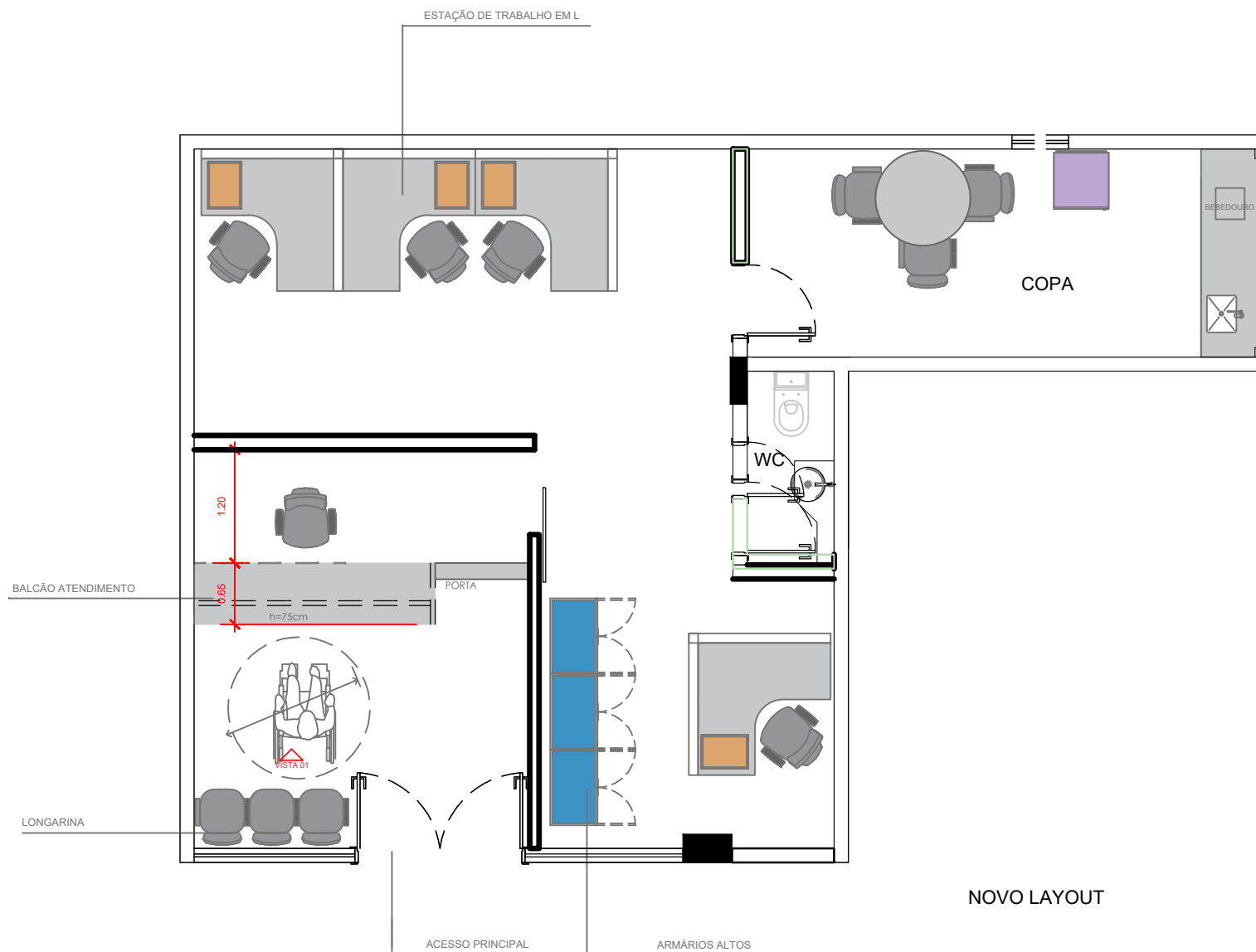

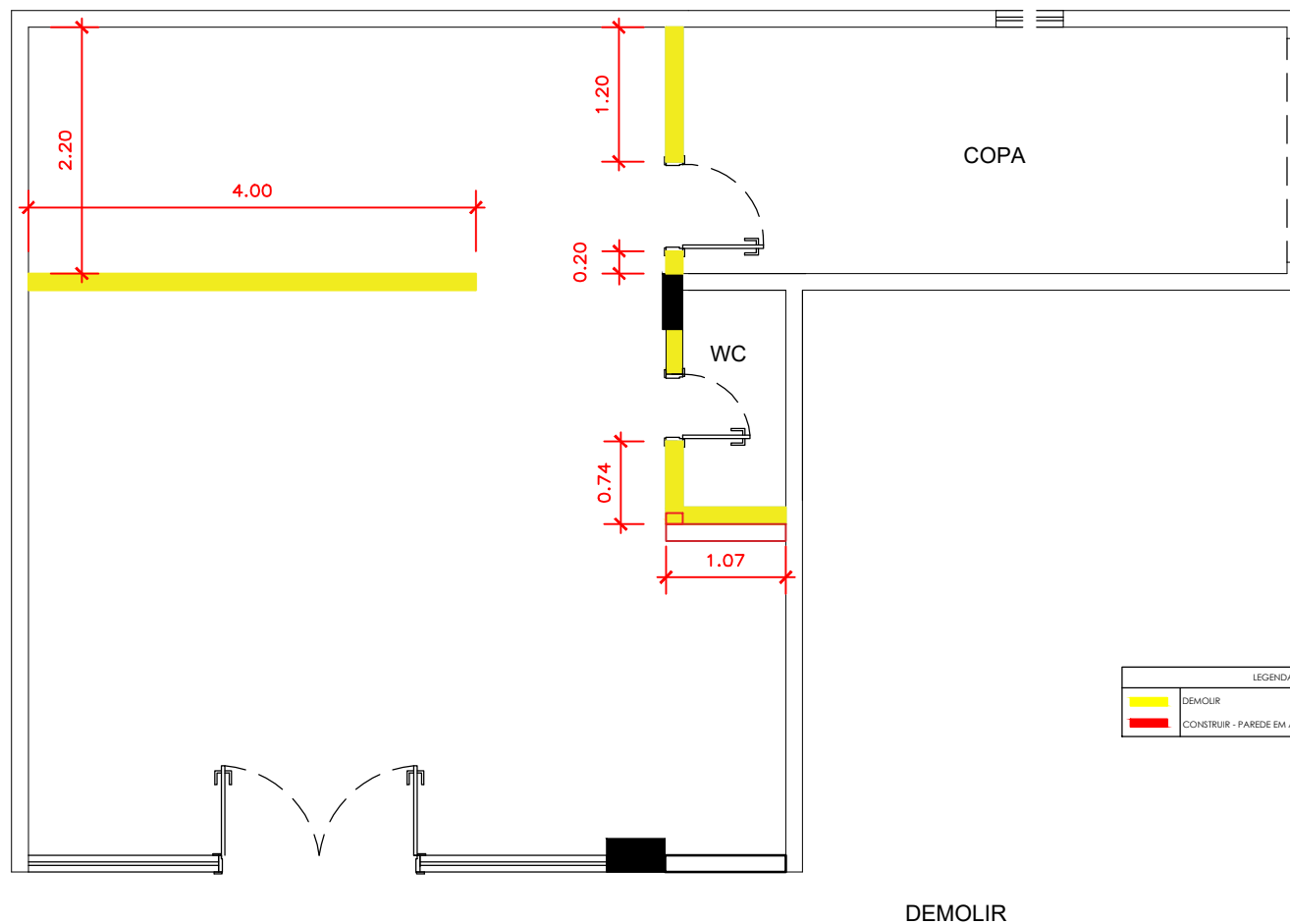

OBS: CONFERIR MEDIDAS NO LOCAL

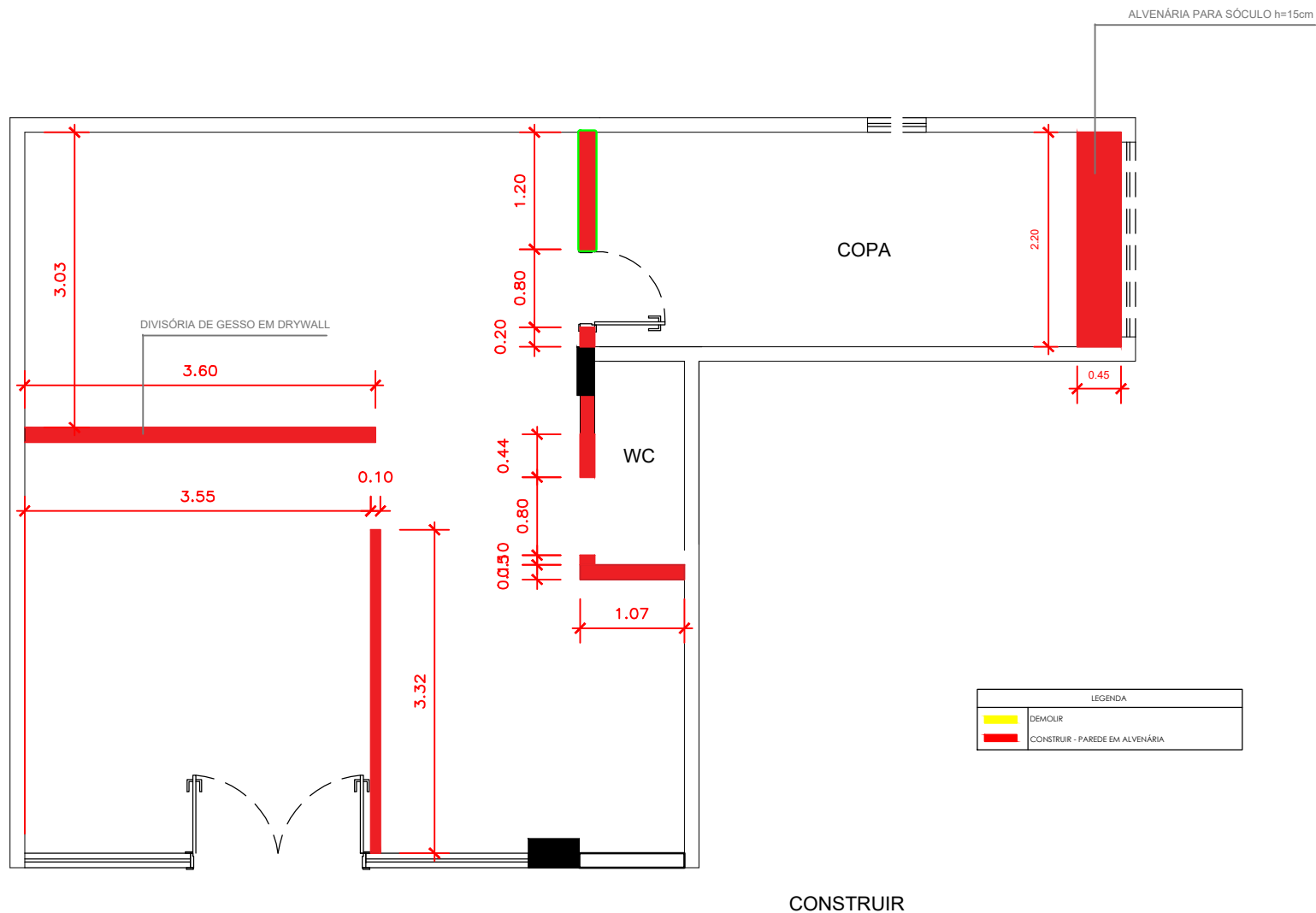

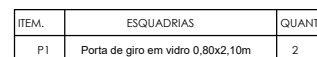

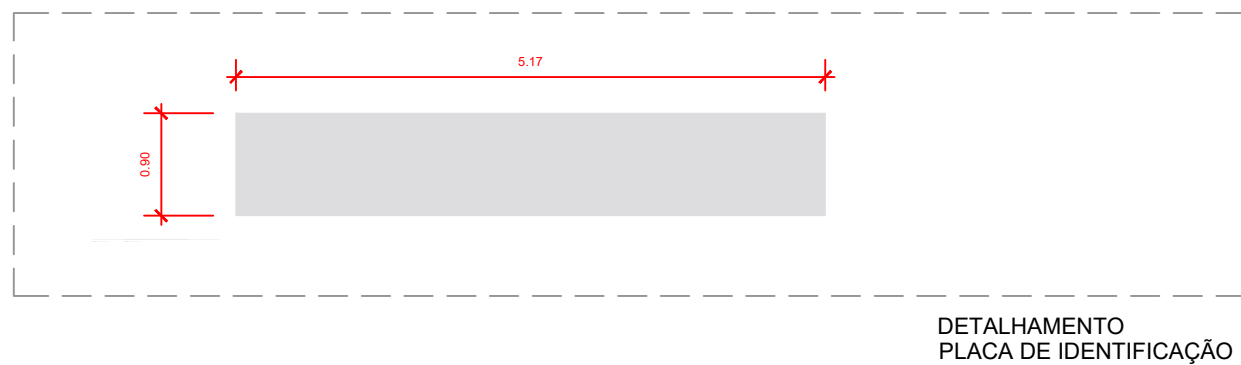
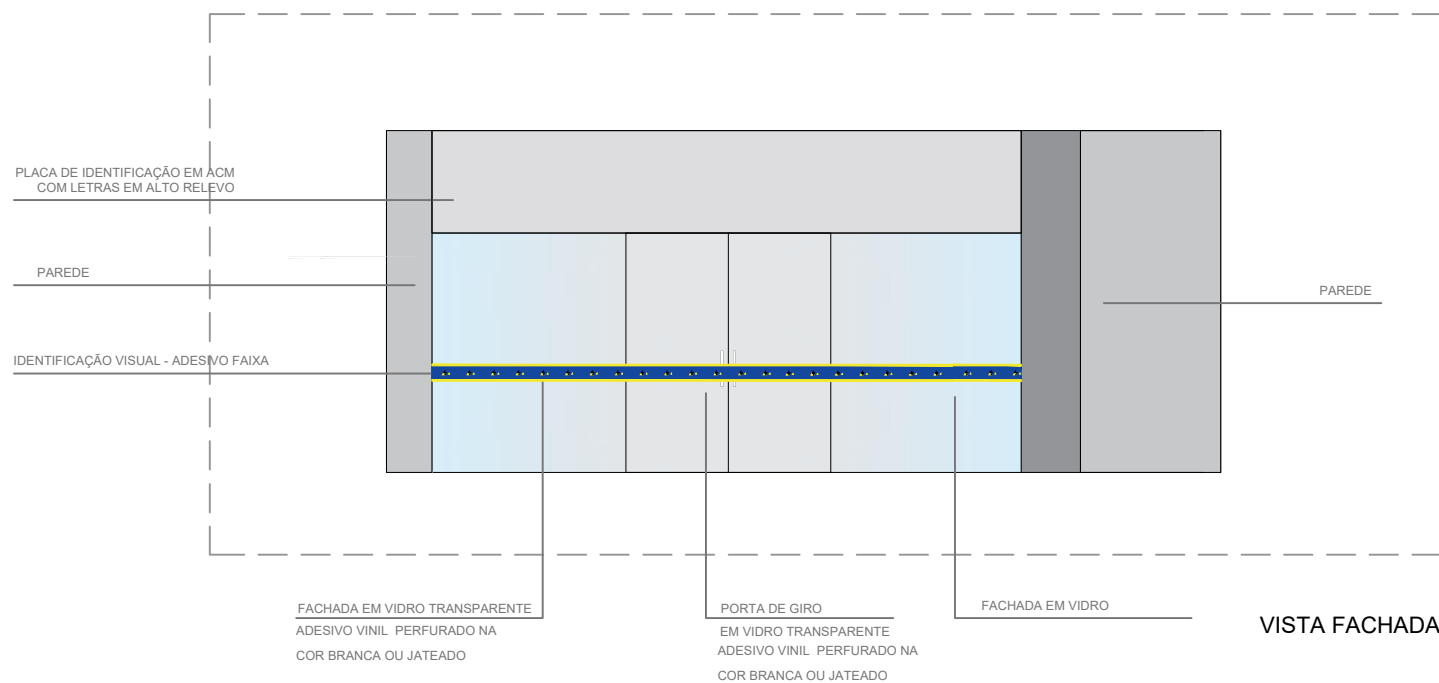

OBS: CONFERIR MEDIDAS NO LOCAL

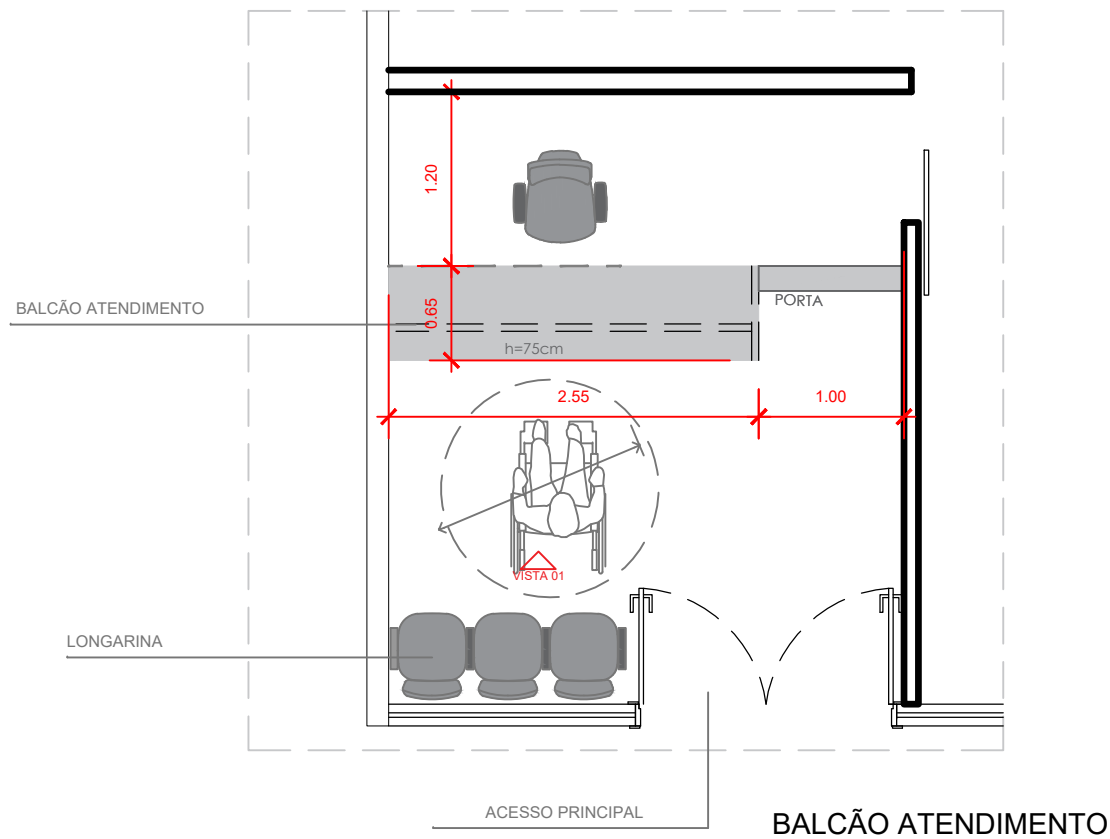

OBS: CONFERIR MEDIDAS NO LOCAL

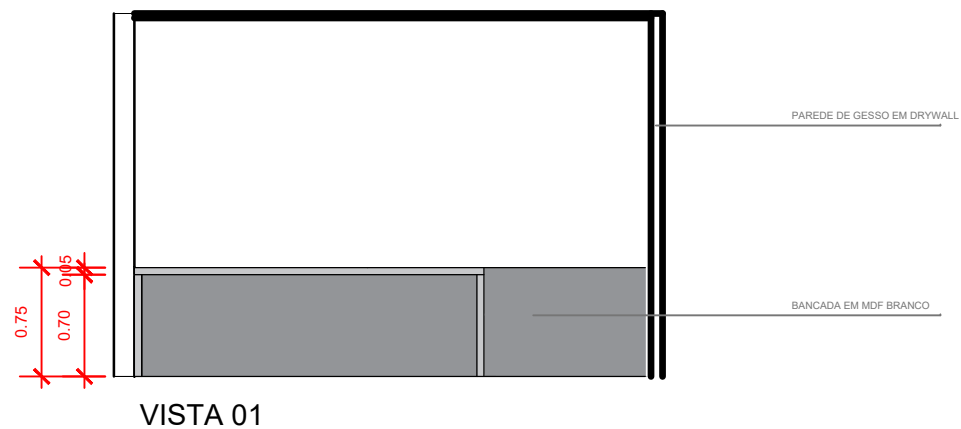

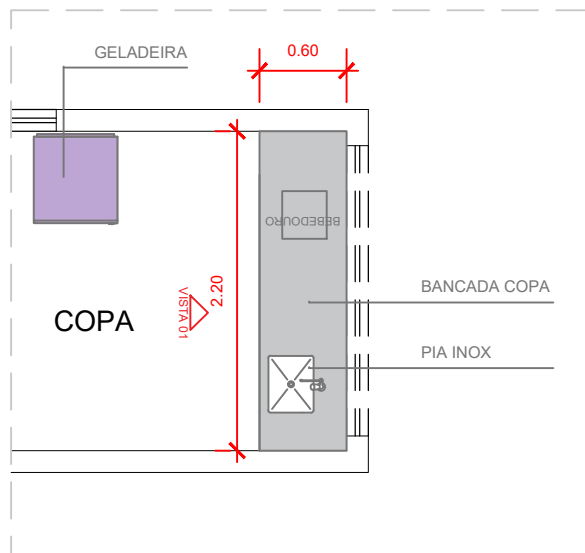

COPA

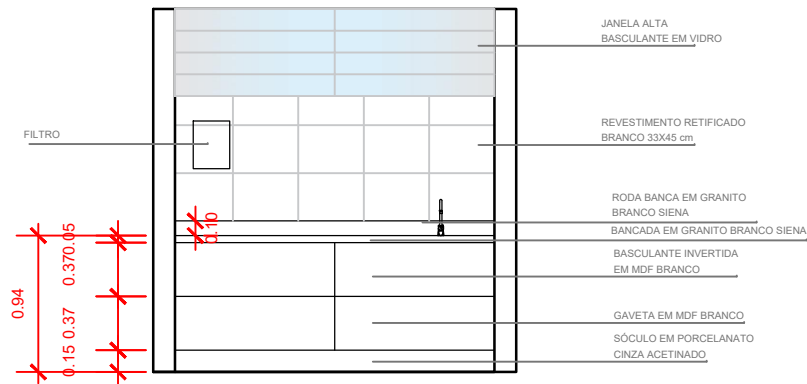

COPA - VISTA 01

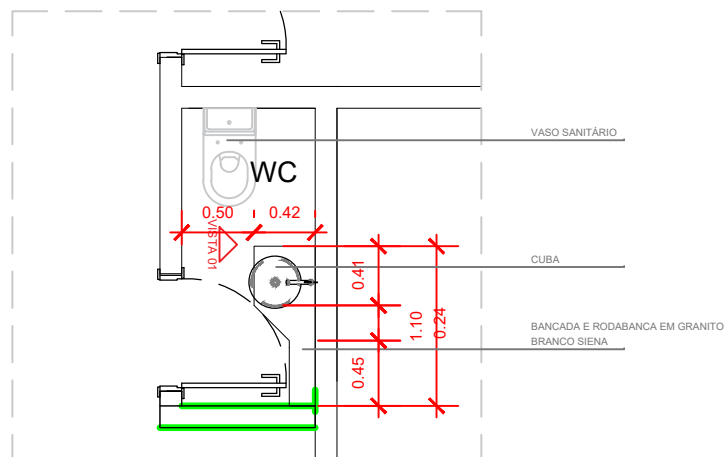

BANHEIRO

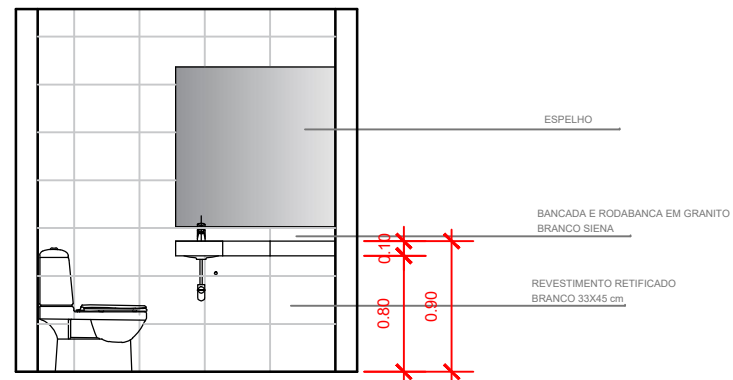

BANHEIRO - VISTA 01

OBS: CONFERIR MEDIDAS NO LOCAL